

SHARP



REFRIGERATOR - FREEZER OPERATION MANUAL

CONTENTS

• WARNING	3
• CAUTION	3
• INSTALLATION	3
• DESCRIPTION	4
• OPERATION	5
• STORING FOOD	8
• CARE AND CLEANING	9
• BEFORE YOU CALL FOR SERVICE	9
• SPECIFICATION	10
• WARRANTY	11



Device of this mark is a trademark of Sharp Corporation.
Plasmacluster is a registered trademark or a trademark of Sharp Corporation.

MODEL
SJ-GC584R

Thank you very much for buying this SHARP product. Before using your SHARP refrigerator, please read this operation manual to ensure that you gain the maximum benefit from it.

Household use only

WARNING

- This refrigerator contains flammable refrigerant (R600a: isobutane) and insulation blowing gas (cyclopentane). Observe the following rules to prevent ignition and explosion.
 - The refrigeration system behind and inside the refrigerator contains refrigerant. Do not allow any sharp objects to come into contact with the refrigeration system.
 - Do not use mechanical devices or other means to accelerate the defrosting process. (This refrigerator has adopted automatic defrosting system.)
 - Do not use electric appliances inside the refrigerator.
 - Use only the specified parts for the refrigerator compartment light.
 - Do not block the openings on the circumference of the refrigerator.
 - Do not use flammable sprays, such as spray paint near the refrigerator. It may cause explosion or fire.
 - If the refrigeration system should get punctured, do not touch the wall outlet and do not use open flames. Open the window and air out the room. Then ask a service agent approved by SHARP for servicing.
 - This refrigerator should be disposed appropriately. Take the refrigerator to a recycling plant for flammable refrigerant and insulation blowing gases.
- Do not store highly volatile and flammable materials such as ether, petrol, propane gas, aerosol cans, adhesive agents and pure alcohol etc. These materials are liable to explode.
- Dust deposited on the power plug may cause fire. Wipe it off carefully.
- Do not attempt to change or modify this refrigerator. This may result in fire, electric shock or injury.
- Ensure that the refrigerator presents no danger to children while being stored for disposal. (e.g. remove the magnetic door seals to prevent child entrapment.)

CAUTION

- Attention about Power supply:
 - Do not use an extension cord or adapter plug.
 - Make sure that the power cord has not been damaged during installation or moving. If the power plug or cord is loose, do not insert the power plug. There is a risk of electric shock or fire.
 - Disconnect from the mains electricity supply by removing the mains plug from the electricity supply socket. Do not remove by pulling the mains lead. This may cause electric shock or fire.
 - Should the flexible supply cord be damaged, it must be replaced by a service agent approved by SHARP as a special cord is required.
- Do not touch the compressor unit or its peripheral parts, as they become extremely hot during operation and the metal edges may cause injury.
- Do not touch foods or metal containers in the freezer compartment with your wet hands. This may cause frostbite.
- Do not place bottled and canned drinks in the freezer as they may crack or explode when frozen.
- In case of gas leak, ventilate the area by opening a window, etc. Do not touch the refrigerator or the power outlet.
- Do not place objects containing liquid or unsteady objects on top of refrigerator.
- This refrigerator is not intended for use by persons (including children) with reduced physical, sensory or mental capabilities, or lack of experience and knowledge, unless they have been given supervision or instruction concerning use of the refrigerator by a person responsible for their safety. Young children should be supervised to ensure that they do not play with the refrigerator.

INSTALLATION

WARNING

- Do not install the refrigerator in a damp or wet location as this may cause damage to the insulation and create a leak. Condensation may also build on the outer cabinet and cause rust.

- 1 Keep adequate ventilation space around the refrigerator.
 - The figure shows the minimum required space for installing the refrigerator. The amount of space around the refrigerator affects the amount of power consumption.
 - Insufficient spacing will decrease cooling efficiency and increase energy consumption. This may reduce the life of the unit and void warranty.

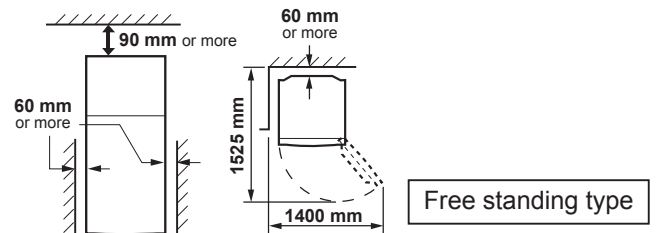

- 2 Use the two front adjustable feet, to ensure that the refrigerator is positioned firmly and flat on the floor.
- 3 Remove the 2 screws of the cabinet lower part, and then set the foot cover (supplied inside the refrigerator compartment) with removed 2 screws.

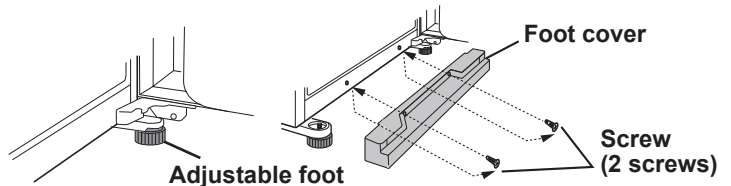

- 4 Connect the power plug to a 230/240 volt. 10 amp. power point.

NOTE

- Position your refrigerator so that the plug is accessible.
- Keep your refrigerator out of direct sunlight.
- Do not place next to heat generating appliance.
- Do not place directly on the ground. Provide suitable stand.
- If the mains power is switched on when the door is open, the door alarm will sound. Close the door to stop the alarm.

When transporting

- The casters allow the refrigerator to move back and forth.
- Carry the refrigerator by holding the handles located on the rear and the bottom.

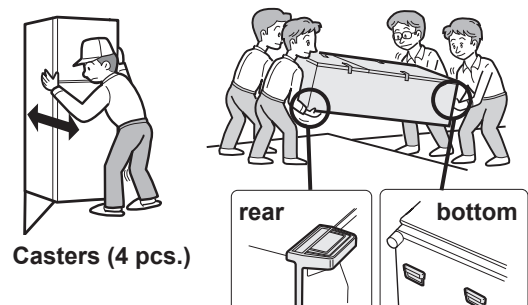

Before using your refrigerator

Clean the inside parts with a cloth soaked in warm water. If soapy water is used, wipe it off thoroughly with water.

DESCRIPTION

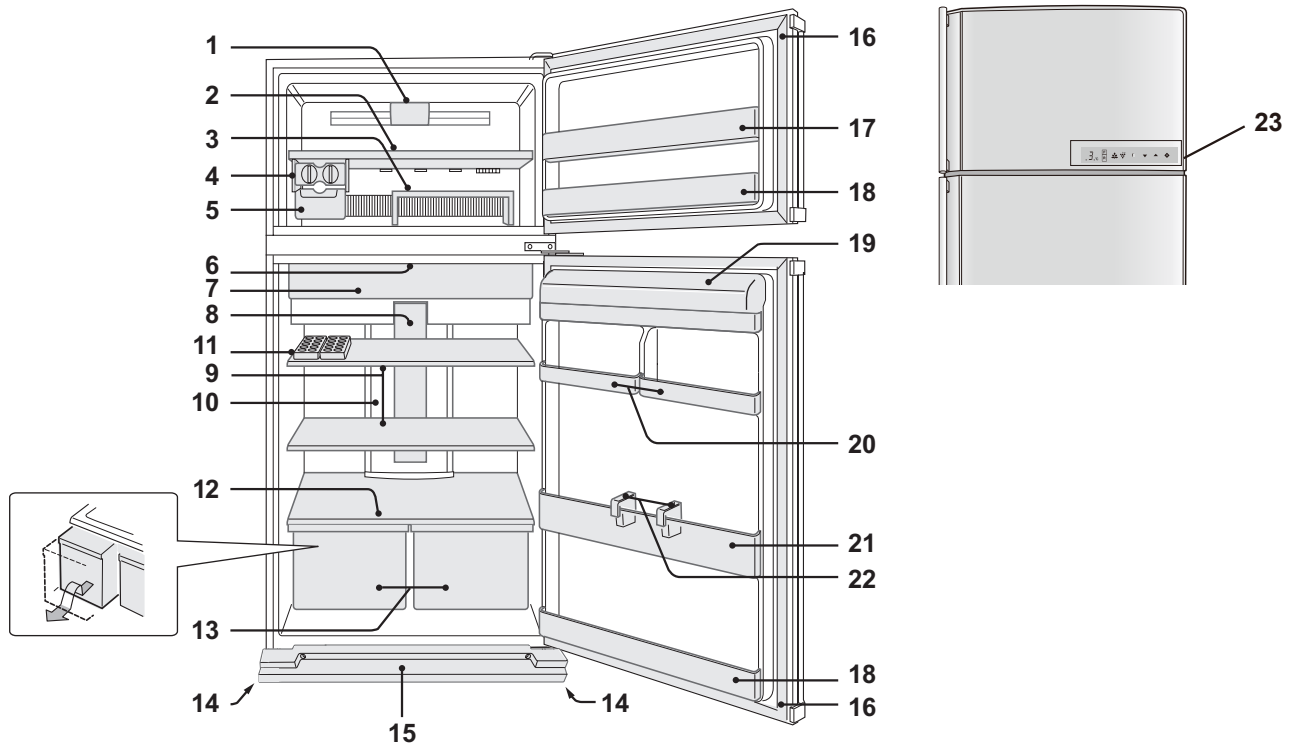

1. Freezer LED light

2. Freezer shelf

3. Movable shelf

You can make two levels, enabling you to store food separately. If used upside down, you can keep foods neatly within this shelf.

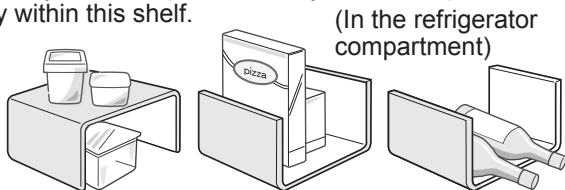

(In the refrigerator compartment)

4. Ice cube maker

- 1) Do not over fill the Ice cube trays; otherwise the ice cubes will be joined together when frozen.
- 2) When the ice cubes are made, turn the lever clockwise to empty the ice into the Ice cube box.

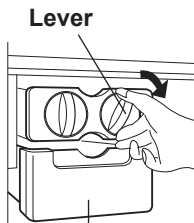

Ice cube box

NOTE To prevent damage to the Ice cube box, do not make ice in the Ice cube box or pour oil into it.

5. Ice cube box

6. Deodorising unit

No operation and cleaning are required.

7. Fresh case & door

8. Refrigerator LED light (Blue & white)

9. Refrigerator shelves (2 pcs.)

10. Hybrid cooling panel (Aluminum panel)

The panel is cooled from the rear, thus indirectly cools the refrigerator compartment. In this way, food is refrigerated gently, without exposing it to cold air flow.

11. Egg trays (2 pcs.) & stopper

How to take out the stopper

- 1) Pull the refrigerator shelf slightly toward you.
- 2) Move the stopper to the center of the shelf and tilt it upward.

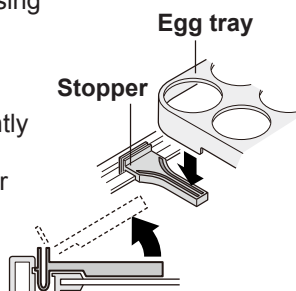

12. Fruit and vegetable shelf

13. Fruit and vegetable crisper (2 pcs.)

14. Adjustable feet (2 pcs.)

15. Foot cover

16. Magnetic door seals (2 pcs.)

17. Flexible pocket

Tall food items (e.g. pizza box) can be stored by lifting the partition from the bottom of the pocket.

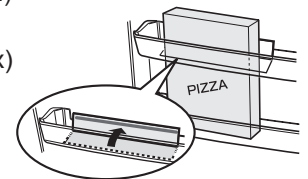

18. Door pockets (2 pcs.)

19. Refrigerator pocket & cover

20. Utility pockets (2 pcs.)

21. Bottle pocket

22. Bottle stopper / Tube stands (2 pcs.)

Prevents bottles etc. from falling. Stick-type food products stored inside.

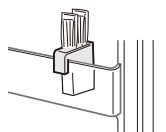

23. Touch control panel

If you wish to store large items within your refrigerator

You may remove any of the items "Fresh case" and "Fruit and vegetable crisper".

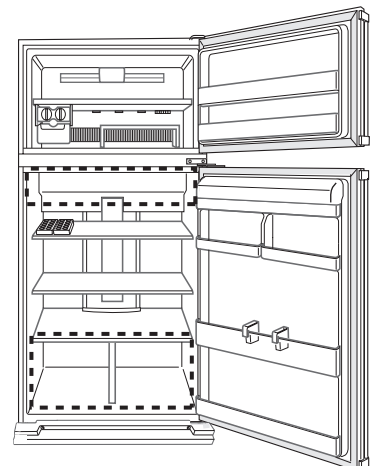

OPERATION

Touch control panel

To operate, touch the keys with your bare hand.

Features start automatically like right figure when inserting the power plug. (At first, Door alarm and Sound are "ON".)

<Standby display>

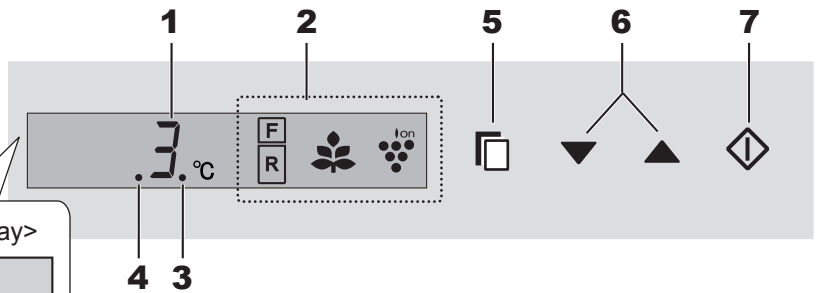

1. Display for temperature setting

The preset temperature of selected compartment is displayed. It is not the actual temperature in the compartment.

2. Display for feature icon

The icon and are displayed on the standby display when each feature is in operation.

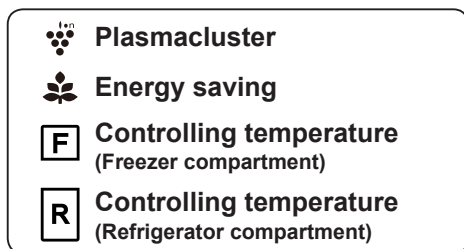

3. Door alarm indication

This indication shows door alarm "ON".

4. Sound ON/OFF indication

This indication shows sound "OFF".

5. Select key

Press to select feature icon and door alarm signal.

6. ▼ / ▲ key

Press to select feature ON/OFF or temperature setting.

7. ⬇ (Enter) key

Finalize the setting.

NOTE

- When there is no operation for 1 minute, the display automatically return to the standby display. Additionally, the display will be turned off when there is no operation for 1 minute.
- When either of the key is pressed, the icons will blink once and show the standby display. When the refrigerator stops with power failure, the display shows similarly as before having a power failure at the time of re-power distribution.

Plasmacluster

The ionizer inside your refrigerator releases clusters of ions, which are collective masses of positive and negative ions, into the refrigerator compartment. These ion clusters inactivate airborne mould fungus.

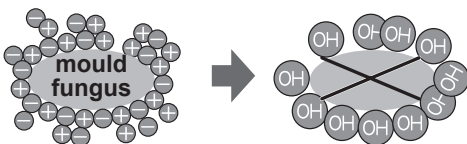

To start operation

- Press the select key and select Plasmacluster icon.



- Press the ▲ key. [▲ : ON, ▼ : OFF]



- Press the ⬇ key.



To cancel operation

It is the same method as starting operation. Press the ▼ key in step 2.



NOTE

- There may be a slight odour in the refrigerator. This is the smell of ozone generated by the ionizer. The amount of ozone is minimal, and quickly decomposes in the refrigerator.

Energy Saving

Use this feature when you want to switch the appliance to energy-saving operation.

To start operation

- 1 Press the select key and select Energy saving icon.



- 2 Press the ▲ key. [▲ : ON, ▼ : OFF]



- 3 Press the ◇ key.



To cancel operation

It is the same method as starting operation.
Press the ▼ key in step 2.



NOTE

- While this feature is operating, the inside temperature of the refrigerator and freezer compartment will be higher than the preset temperature as follows ; R: about 1°C, F: about 2°C. (If the preset temperature is set at R: 3°C, F: -18°C.) The displayed temperature will not be changed.
- The efficiency of power saving depends on the usage environment (controlling temperature, ambient temperature, frequency of opening or closing the door, amount of food).
- Cancel this feature when you feel the beverages are not cooled enough or ice making takes time.

Door Alarm

- At first, door alarm is set "ON".
- When the refrigerator or freezer door is left open, the door alarm will sound.
- The door alarm will sound in 1 minute after opening the door and again after 1 minute (once in each case).
- If the door is left open for approx. 3 minutes, the alarm will sound continuously.

To cancel operation

- 1 Press the select key and select the door alarm indication like the below figure.

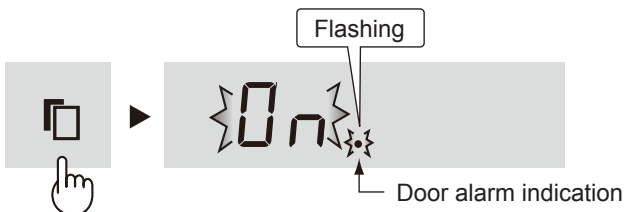

- 2 Press the ▼ key. [▲ : ON, ▼ : OFF]



- 3 Press the ◇ key.



To start operation

It is the same method as canceling operation.
Press the ▲ key in step 2.



Controlling Temperature

The refrigerator controls its temperature automatically. However, if needed, adjust the temperature as follows.

Freezer compartment

Adjustable between -13°C and -21°C in steps of 1°C.

- 1 Press the select key and select **F** icon.
The display shows the current preset temperature.

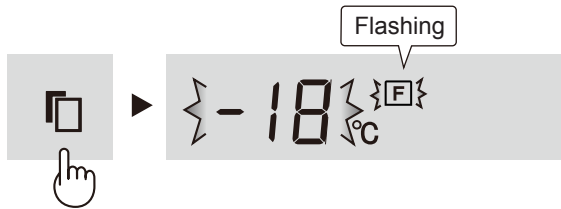

- 2 Press the ▲ / ▼ key and set the temperature.
[▲ : increase, ▼ : decrease]

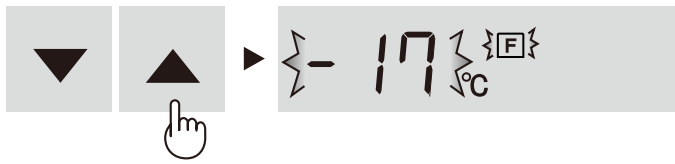

- 3 Press the ◊ key.



Refrigerator compartment

Adjustable between 0°C and 6°C in steps of 1°C.

- 1 Press the select key and select **R** icon.
The display shows the current preset temperature.



- 2 Press the ▲ / ▼ key and set the temperature.
[▲ : increase, ▼ : decrease]



- 3 Press the ◊ key.



Advanced Setting of Freezer / Refrigerator compartment

The temperature of freezer compartment and refrigerator compartment can be adjusted in steps of 0.5 °C by following steps ① to ③ below.

Freezer compartment

- ① Select **F** icon.
Beep beep beep
- ② Press ◊ key continuously for 3 seconds or more.
The current preset temperature on the display will be changed to -18.0 °C.
(The display will be indicated alternately like right figure.)
- ③ Adjust the temperature in the same way as steps 2 to 3 above.

Follow steps ① to ② again if you want to adjust the temperature in steps of 1°C.

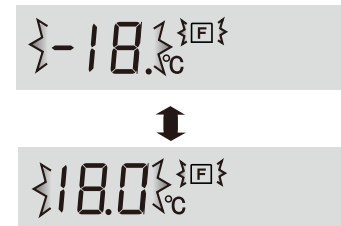

Refrigerator compartment

- ① Select **R** icon.
Beep beep beep
- ② Press ◊ key continuously for 3 seconds or more.
The current preset temperature on the display will be changed to 3.0 °C.
(The display will be indicated like right figure.)
- ③ Adjust the temperature in the same way as steps 2 to 3 above.

Follow steps ① to ② again if you want to adjust the temperature in steps of 1°C.



Sound ON/OFF

- At first, the sound is set "ON".
- Use this feature when you want to switch the sound of key operation to "ON" or "OFF".

To set sound "OFF"

Press the ▼ key and ◊ key simultaneously and continuously for 3 seconds or more again.

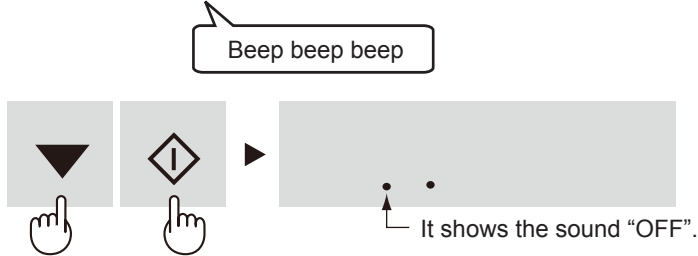

To set sound "ON"

Press the ▼ key and ◊ key simultaneously and continuously for 3 seconds or more.

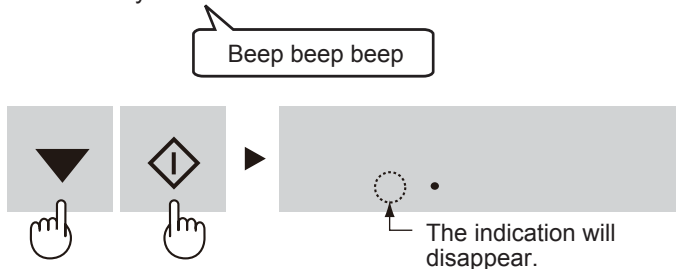

STORING FOOD

Refrigeration reduces the rate of food spoilage. To maximise the shelf life of perishable food products, ensure that the food is of the freshest possible quality. The following is a general guide to help promote longer food storage.

Fruit / Vegetables

To minimize moisture loss, fruit and vegetables should be loosely enclosed in a plastic material (e.g. wrap, bags) and place in the fruit and vegetable crisper.

Dairy Products & Eggs

- Most dairy products have a use by date on the outer packaging which informs the recommended temperature and shelf life of the product.
- Eggs should be stored in the Egg tray.

Meats / Fish / Poultry

- Place on a plate or dish and cover with paper or plastic wrap.
- For larger cuts of meat, fish, or poultry, place to the rear of the shelves.
- Ensure all cooked food is wrapped securely or placed in an airtight container.

NOTE

- Evenly place the food on the shelves to allow the cooling air to circulate efficiently.
- Hot foods should be cooled before storing. Storing hot foods increases the temperature in the unit and increases the risk of food spoilage.
- Do not block the outlet and inlet of the cool air circulating circuit with foods or containers; otherwise the foods will not be evenly cooled throughout the refrigerator.
- Keep the door securely closed.

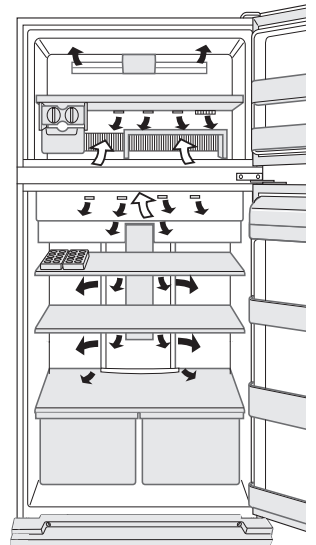

Do not place food directly in front of cold air outlet. This may lead to the food freezing.

For best freezing

- Quality of foods should be fresh.
- Freeze small quantities of food at a time to freeze them quickly.
- Food should be properly sealed, sealed tightly or covered.
- Evenly place the food in the freezer.
- Label bags or containers to keep an inventory of frozen food.

CARE AND CLEANING

WARNING

- Unplug the refrigerator first to prevent electric shock.
- Do not splash water directly on the outer cabinet or the interior. This may lead to rusting and deterioration of the electrical insulation.

IMPORTANT

To prevent cracking on inside surfaces and plastic components, follow these tips.

- Wipe any food oils adhered to plastic components.
- Some household chemicals may cause damage, so use only diluted washing-up liquid (soapy water).
- If undiluted detergent is used or soapy water is not wiped off thoroughly, cracking of plastic parts can result
- Wipe any spills from the refrigerator immediately as acid or alkaline in the food can cause cracking and staining of plastic parts.

- 1 Remove the accessories e.g. shelves from the cabinet and door. Wash them in warm soapy dishwashing water; rinse in clean water and dry. (Only fruit and vegetable shelf is not removable)
- 2 Clean the inside with a cloth soaked in warm soapy dishwashing water. Then, use cold water to wipe off soapy water.
- 3 Wipe the exterior with a soft cloth each time it is soiled.
- 4 Clean the Magnetic door seal with a toothbrush and warm soapy dishwashing water.
- 5 Wipe the touch control panel with the dry cloth.

NOTE

- Do not use hot water, household cleaning powders, creams or spray-on cleaning products, or any other cleaning products such as mineral turpentine, methylated spirits, thinners, petrol etc. These may damage your refrigerator and may void any warranty.
- If the power supply is disconnected, please wait for at least 5 minutes before re-connecting power.
- The glass shelves weigh approximately 3 kg each. Hold firmly when removing from the cabinet or carrying.
- Do not drop objects inside the refrigerator or strike the inner wall. This may cause the inner surface to crack.

Defrosting

Defrosting is fully automatic due to a unique energy saving system.

When the compartment light is blown

Contact a service agent approved by SHARP to request a replacement compartment light. The compartment light is not to be removed other than by qualified service personnel.

Switching off your refrigerator

If the refrigerator needs to be switched off for an extended period, the following steps should be taken to reduce the growth of mould:

1. Remove all food.
2. Remove the power plug from the power point.
3. Clean and dry the interior thoroughly.
4. Ensure that all the doors are wedged open slightly for air circulation.

BEFORE YOU CALL FOR SERVICE

Before you call for service, check the following points.

Problem	Solution
The outside of the cabinet is hot when touched.	This is normal. The hot pipe is in the cabinet in order to prevent condensation generation.
When there is refrigerator noise.	It is normal for the refrigerator to produce the following sounds. <ul style="list-style-type: none"> • Loud noise produced by the compressor when operation starts --- Sound becomes quieter after a while. • Loud noise produced once a day by the compressor --- Operating sound produced immediately after automatic defrost operation. • Sound of flowing fluid (gurgling sound, fizzing sound) --- Sound of refrigerant flowing in pipes (sound may become louder from time to time). • Cracking or crunching sound, squeaking sound --- Sound produced by expansion and contraction of inner walls and internal parts during cooling.
Frosting or condensation generation occurs inside or outside the refrigerator.	This may occur in one of the following cases. Use a wet cloth for wiping frost and a dry cloth for wiping condensation. <ul style="list-style-type: none"> • When the ambient humidity is high. • When the door is frequently opened and closed. • When food containing plenty of moisture is stored. (Wrapping is required.)
The foods in the refrigerator compartment freeze.	<ul style="list-style-type: none"> • Is the refrigerator operated for a long time with refrigerator temp. control set at 0°C? • Is the refrigerator operated for a long time with freezer temp. control set at -21°C? • Low ambient temperature may cause food to freeze even if refrigerator temp. control is set to 6°C.
Noticeable odours.	<ul style="list-style-type: none"> • Wrapping is required for food with strong odours. • Deodorising unit cannot remove all of the odours.
Touch control panel does not work.	This may occur in one of the following cases. <ul style="list-style-type: none"> • The panel or your finger is soiled with dripping, oil and etc. • Touch the panel with gloved hand, adhesive bandage on your finger, nail or objects. • Sticker or tape is affixed on the keys. • Touch position is slightly off from the keys. • Operate time is not enough for the keys to work.

If you still require service contact your SHARP Approved Service Centre.

SHARP Approved Service Centre locations can be found in the Support area of our website:

Australia : <http://www.sharp.net.au>

New Zealand : <http://www.sharp.net.nz>

SPECIFICATION

	SJ-GC584R	
Rated voltage (V~)	220 - 240	
Rated frequency (Hz)	50	
Rated current (A)	0.7 - 0.8	
Rated input of heating systems (W)	145 - 170	
Defrosting input (W)	145 - 170	
Climate class	T	
Refrigerant	R600a	
Charge (g)	65	
Insulation blowing gas	Cyclo pentane	
Rated storage volume (L)	541	
Rated gross volume (L)	585	
Group (AS / NZS 4474.1)	5T	
Net weight (kg)	87	
Outer dimensions (mm)	Height	1750
	Width	800
	Depth	720

SHARP WARRANTY

Consumer Electronic Products

Congratulations on Your Purchase!

This Sharp product is warranted against faults in material and manufacture for the period as stated in the table below.

If service is required during the warranty period, please contact your nearest Sharp Approved Service Centre. These repairs would be carried out at no charge to the owner, subject to the conditions specified herein.

This warranty does not extend to defects or injuries caused by or resulting from causes not attributable to faulty parts or the manufacture of the product, including but not limited to, defect or injury caused by or resulting from misuse, abuse, neglect, lack of maintenance, accidental damage, improper voltage, liquid spillage, vermin infestation, software, or any alterations made to the product which are not authorised by Sharp.

Please retain your sales documentation, as this should be produced to validate a warranty claim. This warranty is in addition to and in no way limits, varies or excludes any implied rights and remedies under any relevant legislation in the country of sale.

This warranty does not cover transportation to and from the Sharp Approved Service Centre. Goods presented for repair may be replaced by refurbished goods of the same type rather than being repaired. Refurbished parts may be used to repair the goods. The repair of your goods may result in the loss of user generated data, please ensure that you have saved this data elsewhere prior to repair.

Australian customers: Our goods come with guarantees that cannot be excluded under the Australian Consumer Law. You are entitled to a replacement or refund for a major failure and for compensation for any other reasonably foreseeable loss or damage. You are also entitled to have the goods repaired or replaced if the goods fail to be of acceptable quality and the failure does not amount to a major failure. The criteria of a major failure is defined in the Australian Consumer Law. Should you require any assistance with a major failure please contact Sharp Customer Care.

WARRANTY PERIODS

Home Theatre Projector	12 months (excluding lamps and air filters)
Audio/Home Theatre	12 months
Microwave Oven	12 months
Steam Oven	12 months
Refrigerator	24 months
DVD/Blu-ray	12 months
Air Conditioner	60 months
Portable Air Conditioner	12 months
LCD Television	36 months
Air Purifier	12 months

SHARP

SHARP CORPORATION OF
AUSTRALIA PTY. LIMITED
ABN 40 003 039 405
1 Huntingwood Drive
Huntingwood NSW 2148

SHARP CORPORATION OF
NEW ZEALAND LIMITED
59 Hugo Johnston Drive
Penrose, Auckland

SPform 040 (AUGUST 2011)

IMPORTANT NOTICE: This warranty applies only to products sold in Australia & New Zealand

SHARP

FOR LOCATION ENQUIRIES WITHIN

AUSTRALIA

REGARDING YOUR LOCAL

SHARP APPROVED SERVICE CENTRE

VISIT OUR WEBSITE AT

www.sharp.net.au

OR CALL SHARP CUSTOMER CARE

1300 135 022

(LOCAL CALL COSTS APPLY WITHIN AUSTRALIA)

SHARP CORPORATION OF AUSTRALIA PTY LTD

SHARP

FOR LOCATION ENQUIRIES WITHIN

NEW ZEALAND

REGARDING YOUR LOCAL

SHARP APPROVED SERVICE CENTRE

VISIT OUR WEBSITE AT

www.sharp.net.nz

CONTACT YOUR SELLING DEALER/RETAILER

OR CALL

SHARP CUSTOMER SERVICES

TELEPHONE: 09 573 0111

FACSIMILE: 09 573 0113

SHARP CORPORATION OF NEW ZEALAND LIMITED

SHARP

SHARP CORPORATION OF AUSTRALIA PTY.LTD.

A. B. N. 40 003 039 405

1 HUNTINGWOOD DRIVE, HUNTINGWOOD, N.S.W. 2148

P.O.BOX 6827, BLACKTOWN. N.S.W. 2148

SHARP CORPORATION OF NEW ZEALAND LIMITED

59 HUGO JOHNSTON DRIVE P.O. BOX 12244, PENROSE, AUCKLAND

Printed in Thailand

TINS-B344CBRZ 12FK (TH) ①

Free Manuals Download Website

<http://myh66.com>

<http://usermanuals.us>

<http://www.somanuals.com>

<http://www.4manuals.cc>

<http://www.manual-lib.com>

<http://www.404manual.com>

<http://www.luxmanual.com>

<http://aubethermostatmanual.com>

Golf course search by state

<http://golfingnear.com>

Email search by domain

<http://emailbydomain.com>

Auto manuals search

<http://auto.somanuals.com>

TV manuals search

<http://tv.somanuals.com>