

*Sunbeam*

# Water Purifier

Instruction Booklet  
WF7400

Please read these instructions carefully  
and retain for future reference.



# Contents

Sunbeam's Safety Precautions	1
Features of your Water Purifier	2
Safe, Clean Drinking Water	4
Using your Water Purifier	5
Using your Fridge Jug	6
Care and Cleaning	7
Sunbeam Water Purifier Performance Data	8

## Important instructions – retain for future use.

If you have any concerns regarding the performance and use of your appliance, please ring our Customer Service Line on 1300 881 861. In New Zealand - contact Sunbeam on 0800 786 232.

**Ensure the above safety precautions are understood.**

تأكد من تفهم احتياطات السلامة المذكورة اعلاه

請務必理解上述的安全預防措施。

Assurez-vous que les précautions ci-dessus relatives à la sécurité sont bien comprises

Versichern Sie sich, dass die obenstehenden Sicherheitsmaßnahmen verstanden werden

Βεβαιώνετε πως οι παραπάνω προφυλάξεις ασφαλείας γίνονται κατανοητές

Pastikan bahwa tindakan-tindakan keselamatan seperti di atas dimengerti anda

Accertatevi che le suddette norme di sicurezza siano comprese a dovere

上記の注意事項をよくお読みになり、安全を御確認ください

Уверете се дека погоре споменатите мерки на претпазливост се добро разбрани

Asegúrese de que las precauciones de seguridad precedentes sean bien comprendidas

کاری بکنید کہ احتیاط‌های بالا حتماً درک بشوند

ต้องแน่ใจว่า ข้อควรระวังเรื่องความปลอดภัยข้างต้น เป็นที่เข้าใจกันดี

Yukarda belirtilen güvenlik önlemlerinin anlaşıldığından emin olunuz

Xin kiểm chắc rằng những biện pháp làm an toàn kể trên được hiểu rõ

# Sunbeam's Safety Precautions

## SAFETY PRECAUTIONS FOR YOUR SUNBEAM WATER PURIFIER.

- This appliance must only be used with municipally treated water. Do not attempt to filter untreated, raw or water of unknown quality.
- Regular filter replacement is essential for the appliance to perform as represented. The filter must be replaced at least every six months.
- To protect against electric shock, do not place

**Sunbeam is very safety conscious when designing and manufacturing consumer products, but it is essential that the product user also exercise care when using an electrical appliance. Listed below are precautions which are essential for the safe use of an electrical appliance:**

- Read carefully and save all the instructions provided with an appliance.
- Always turn the power off at the power outlet before you insert or remove a plug. Remove by grasping the plug - do not pull on the cord.
- Turn the power off and remove the plug when the appliance is not in use and before cleaning.
- Do not use your appliance with an extension cord unless this cord has been checked and tested by a qualified technician or service person.
- Always use your appliance from a power outlet of the voltage (A.C. only) marked on the appliance.
- This appliance is not intended for use by persons (including children) with reduced physical, sensory or mental capabilities, or lack of experience and knowledge, unless they have been given supervision or instruction concerning use of the appliance by a person responsible for their safety.
- Children should be supervised to ensure that they do not play with the appliance.
- The temperature of accessible surfaces may be high when the appliance is operating.
- the cord plug or the appliance in water or any other liquid.
- Always place the appliance on a flat level surface.
- Always unplug the appliance before changing the filter.
- This appliance has been designed to be used continuously.
- Never leave an appliance unattended while in use.
- Do not use an appliance for any purpose other than its intended use.
- Do not place an appliance on or near a hot gas flame, electric element or on a heated oven.
- Do not place on top of any other appliance.
- Do not let the power cord of an appliance hang over the edge of a table or bench top or touch any hot surface.
- Do not operate any electrical appliance with a damaged cord or after the appliance has been damaged in any manner. If damage is suspected, return the appliance to the nearest Sunbeam Appointed Service Centre for examination, repair or adjustment.
- For additional protection, Sunbeam recommend the use of a residual current device (RCD) with a tripping current not exceeding 30mA in the electrical circuit supplying power to your appliances.
- Do not immerse the appliance in water or any other liquid unless recommended.
- Appliances are not intended to be operated by means of an external timer or separate remote control system.
- This appliance is intended to be used in household and similar applications such as: staff kitchen areas in shops, offices and other working environments; farm houses; by clients in hotels, motels and other residential type environments; bed and breakfast type environments.

# Features of your Water Purifier

Removable lid

4.3 litre external water tank

2 litre fridge jug

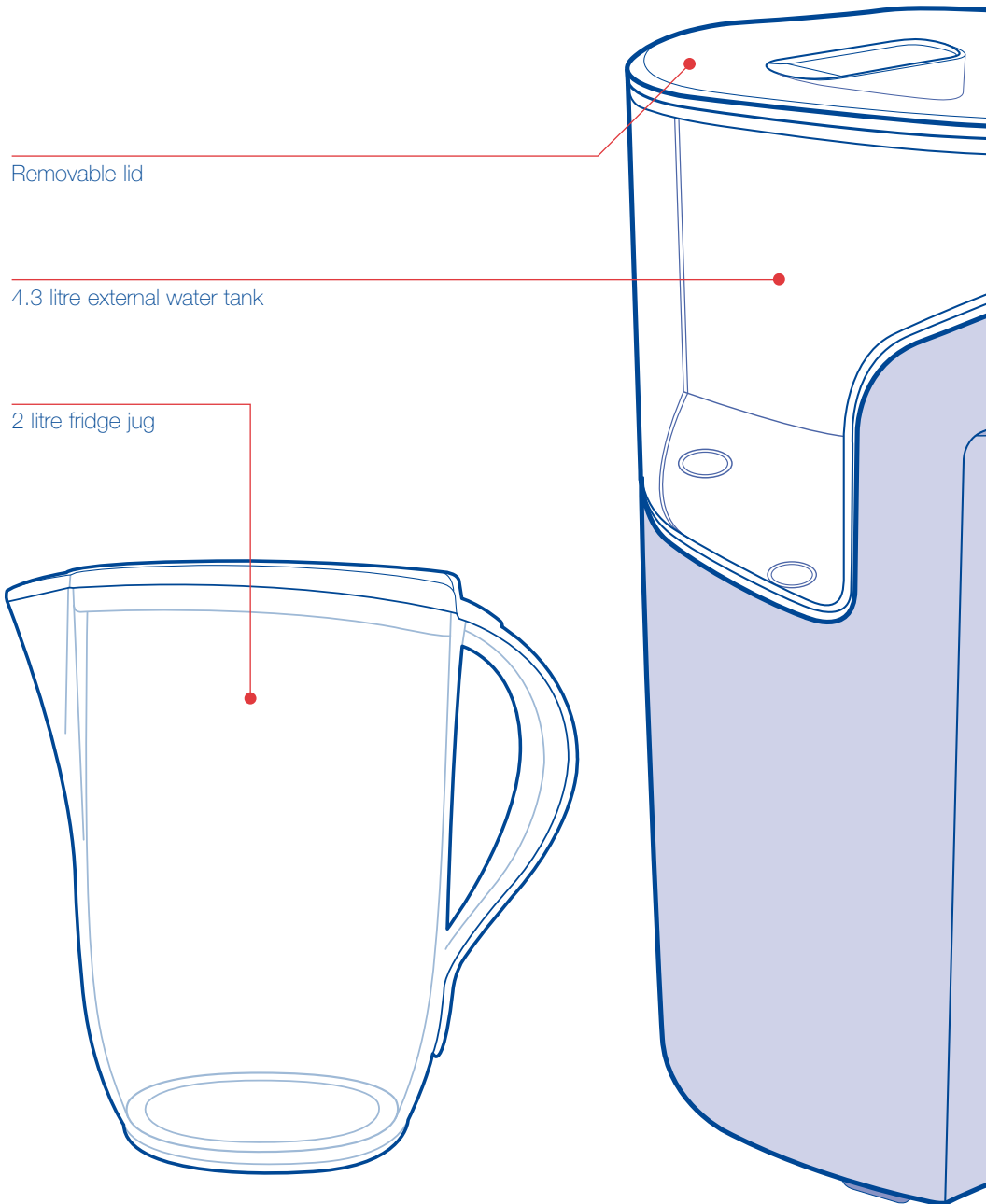

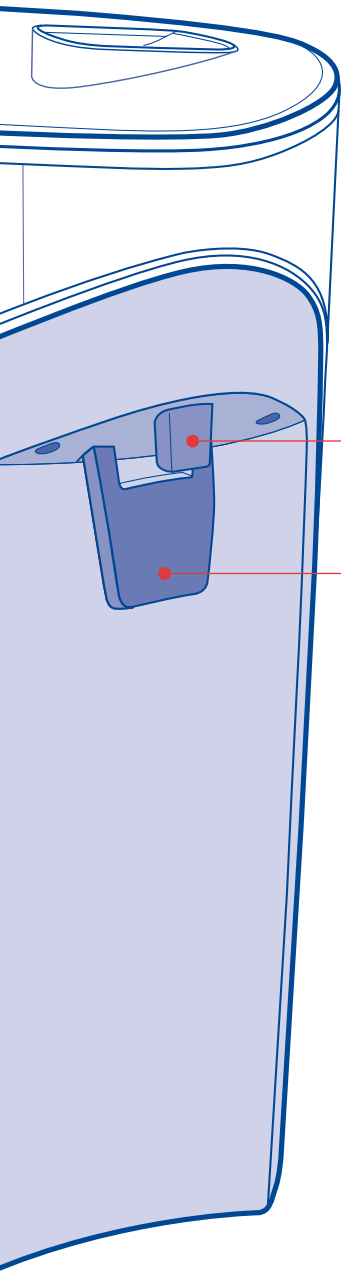

Spout

Dispensing paddle switch

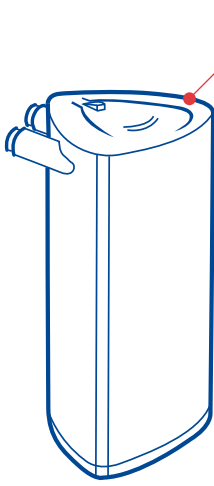

Filter cartridge

# Safe, Clean Drinking Water

The Sunbeam Water Purifier features a micro-fine 0.5 micron carbon block filter which removes contaminants from water that can cause bad taste and odour, as well as being harmful to your health.

Some of the potential contaminants of concern are listed below, along with the sources of each and their potential health effects.

Contaminant	Source	Health Effect
Lead	Lead can enter your water from lead plumbing, lead solder and brass alloy taps.	Lead can interfere with red blood cells, delay physical and mental development in babies and children, increase blood pressure and damage kidneys in adults.
Cysts (Cryptosporidium & Giardia)	Main source is from animal faeces containing the cysts. Run off carries cysts into lakes and rivers. A hard shell protects these micro-organisms from the chlorine disinfection.	Cysts can cause acute flu like symptoms that can last one to three weeks in healthy adults. Effects on children or the elderly can be more serious and life threatening for those with suppressed immune systems such as cancer patients or HIV/Aids patients.
Lindane (a common pesticide)	Chemicals can soak through the soil into ground water, or can be carried into lakes and rivers by rainwater run off.	Lindane has been shown to damage liver, kidney, nervous system and immune system in lab animals. At high levels, it has caused nervous and circulatory system damage in humans.

# Using your Water Purifier

## Before using your Sunbeam Water Purifier

- Carefully unpack the appliance and check that all components are included.
- Wipe the appliance with a clean cloth or paper towel. Wash out the inside of the water tank with a cloth moistened with water. Do not use any detergents or cleaning products.
- Plug the appliance into an appropriate electrical outlet and switch on the power.
- This appliance has been designed to be used continuously.
- Keep appliance out of direct sunlight.

## Flushing the filter

- It is important to rinse out the dispensing system before using the appliance for the first time.
- Remove the water tank lid and fill to the maximum level with hot tap water.
- Place a large container or jug under the spout.
- Press the dispensing paddle until all the water has been filtered and the water tank is empty.
- Repeat this flushing process with cold tap water twice to ensure that there is no residual taste.
- The first few jugs of filtered water may contain some black residue from the carbon filter. This is normal and does not indicate that the filter is faulty.
- Disregard these first three jugs of filtered water.
- Do not fill above the MAX level indicated.

## Filter life

The life of the filter will be greatly affected by the quality of your tap water. When you notice that the water is flowing very slowly from the spout, it is time to change the filter. This can vary from one month to six months depending on the area where you live. However it **MUST** be replaced at least every six months to maintain filtering performance. The label on the filter will remind you when to do this.

In addition to the Superfine filter which is supplied with the product, a less fine General Purpose filter is also available and is ideal to use in areas where the mineral content of the water is high. Please note that this filter will not remove giardia and cryptosporidium.

**NOTE:** A reduction in water pressure indicates it's time to change your filter. Replace your filter at least every six months.

## Replacing the filter

- Switch off and unplug the appliance.
- Remove and discard the old filter.
- Remove any black 'o' rings which may have been left behind.
- Remove the two clear plugs from the new filter.
- Wet the new black 'o' ring seals and snap the filter into place.
- Flush the filter as described above.

# Using your Fridge Jug

## Before using your Fridge Jug

- Carefully unpack the jug and discard all packaging.
- Wipe the jug with a clean cloth or paper towel and wash the inside with a cloth moistened with water. Do not use detergents or cleaning products.
- Ensure the spout cover and easy fill lid are securely attached.

## Using your Fridge Jug

- Fill the jug directly from the water purifier through the easy fill lid.
- Keep fridge jug in the door of the fridge to allow water to chill.
- Place fridge jug in the fridge at least 1 hour before using to allow water to chill.



# Care and Cleaning

- Do not use harsh detergents or abrasive cleaners.
- Do not place any part of this appliance in a dishwasher.
- Wipe the unit with a clean cloth or paper towel.
- Wash out the inside of the water tank with a cloth dampened in water. Do not use anything to clean out the tank except water.
- Do not immerse the appliance in water or any other liquid.
- If the appliance is to be moved or if it is to be stored for a prolonged period, we recommend that you drain all water from the tank.

# Sunbeam Water Purifier Performance Data

		<b>Removal</b>	<b>Removal</b>	<b>U.S. EPA</b>	<b>Alkalinity</b>	<b>Temp</b>	<b>Inlet</b>
Substance	Influent Water Avg.	Filter Effluent Avg./Min	Efficiency Avg./Min	Maximum Contaminant Level	(ppm) CaCO <sub>3</sub>	(°C)	pH
Taste, Odour							
Chlorine Reduction	2.2 ppm	<0.01 ppm	CLASS 1 99%	N.A.	N.A.	18	7.7
Particulate Reduction	66,599	1048/1502 (.5 - 1 µm)	CLASS 1 98.4/97.8%	N.A.	N.A.	22	7
<b>Health Effects</b>							
Lead Reduction	160 ppb	4/7 ppb	98/95%	15 ppb	250	18	8.5
Lead Reduction	160 ppb	1/2 ppb	99/99%	15 ppb	43	20	6.8
Mercury Reduction	7 ppb	09./2.0 ppb	87/71%	2 ppb	230	18	8.7
Mercury Reduction	9 ppb	.4/9 ppb	96/89%	2 ppb	11	18	6.8
Lindane Reduction	0.5 ppb	<0.01 /<0.01 ppb	98/97%	0.2 ppb	N.A.	18	7.1
Atrazine Reduction	9.7 ppb	0.1/0.2 ppb	99/98%	3 ppb	N.A.	18	7.6
Cyst. Reduction	52,588	2.8/4.4 (3 - 4µm)	99.99 /99.99%	99.9%	N.A.	22	7
Turbidity Reduction	11 NTU	<0.01/<0.01 NTU	99/99%	5 NTU	N.A.	18	7.1
Output Rated Service Flow	1.9 litre/minute						

# 12 Month Replacement Guarantee

In the unlikely event that this appliance develops any malfunction within 12 months of purchase (3 months commercial use) due to faulty materials or manufacture, we will replace it for you free of charge.

Should you experience any difficulties with your appliance, please phone our customer service line for advice on 1300 881 861 in Australia, or 0800 786 232 in New Zealand. Alternatively, you can send a written claim to Sunbeam at the address listed below. On receipt of your claim, Sunbeam will seek to resolve your difficulties or, if the appliance is defective, advise you on how to obtain a replacement or refund.

Your Sunbeam 12 Month Replacement Guarantee naturally does not cover misuse or negligent handling and normal wear and tear.

Similarly your 12 Month Replacement Guarantee does not cover freight or any other costs incurred in making a claim. Please retain your receipt as proof of purchase.

The benefits given to you by this guarantee are in addition to your other rights and remedies under any laws which relate to the appliance.

Our goods come with guarantees that cannot be excluded under the Australian Consumer Law and under the New Zealand Consumer Guarantees Act.

In Australia you are entitled to a replacement or refund for a major failure and for compensation for any other reasonably foreseeable loss or damage. You are also entitled to have the goods repaired or replaced if the goods fail to be of acceptable quality and the failure does not amount to a major failure.

Should your appliance require repair or service after the guarantee period, contact your nearest Sunbeam service centre.

For a complete list of Sunbeam's authorised service centres visit our website or call:

## **Australia**

[www.sunbeam.com.au](http://www.sunbeam.com.au)

**1300 881 861**

Units 5 & 6, 13 Lord Street  
Botany NSW 2019 Australia

## **New Zealand**

[www.sunbeam.co.nz](http://www.sunbeam.co.nz)

**0800 786 232**

26 Vestey Drive, Mt Wellington  
Auckland, New Zealand

## Need help with your appliance?

Contact our customer service team or visit our website for information and tips on getting the most from your appliance.

### In Australia

Visit [www.sunbeam.com.au](http://www.sunbeam.com.au)

Or call 1300 881 861

### In New Zealand

Visit [www.sunbeam.co.nz](http://www.sunbeam.co.nz)

Or call 0800 786 232

 is a registered trademark.

Made in China.

Due to minor changes in design or otherwise, the product may differ from the one shown in this leaflet.

© Copyright. Sunbeam Corporation Limited 2012.

ABN 45 000 006 771

Units 5 & 6, 13 Lord Street  
Botany NSW 2019 Australia

Unit 3, Building D

26 Vestey Drive

Mt Wellington Auckland

New Zealand

Sunbeam Corporation is a division of GUD Holdings Ltd.

## Free Manuals Download Website

<http://myh66.com>

<http://usermanuals.us>

<http://www.somanuals.com>

<http://www.4manuals.cc>

<http://www.manual-lib.com>

<http://www.404manual.com>

<http://www.luxmanual.com>

<http://aubethermostatmanual.com>

Golf course search by state

<http://golfingnear.com>

Email search by domain

<http://emailbydomain.com>

Auto manuals search

<http://auto.somanuals.com>

TV manuals search

<http://tv.somanuals.com>