



## RT3300MC

### MINI-CAMERA PRE-PACK

This low-profile fixed drone, with its pre-installed camera, can be surface mounted to any indoor ceiling or wall, and provides a low-cost alternative for users who require fixed camera coverage. The 330 line color camera has a 1/4-inch vari-focal 3.0 - 6.0 mm lens with an auto iris.

The 355° pan and 75° tilt mechanism enables the internal camera to be manually positioned in virtually any orientation for flexible viewing requirements. The set screw holds the camera in that fixed position, pointing at the desired camera view.

The compact, lightweight housing is available in two colors: black or white. The drone is easy to install; just connect power and video, and mount the unit via its two mounting screws (provided).

## FEATURES

- Attractive, unobtrusive alternative to standard fixed cameras
- Compact, lightweight design
- Pre-installed camera/lens combination
- 1/4-inch vari-focal 3.0 - 6.0 mm lens
- Auto iris
- 330 TV lines resolution
- Automatic electronic shutter
- Automatic gain control
- Manually adjustable pan and tilt viewing angles
- Choice of camera housing color: black or white
- 12 VDC input
- Low power consumption

## SPECIFICATIONS

### Model Numbers

RT3300MC-VARI .....NTSC Camera, 1/4-inch 3.0 - 6.0 mm  
 vari-focal lens, black housing  
 RT3300MC-VARIW .....NTSC Camera, 1/4-inch 3.0 - 6.0 mm  
 vari-focal lens, white housing

### Operational

Pan Travel .....355° with end stop  
 Tilt Travel .....15° to 90°  
 Internal Synchronization ... Built-in sync generator  
 Video Output Connector ... Female BNC

### Camera

Imager .....Interline transfer 1/4-inch CCD array  
 Scanning System .....2:1 interlace  
 Video Output .....1.0 Vp-p, 75 Ω, composite  
 S/N Ratio .....>46 dB (AGC off)  
 Horizontal Resolution .....330 lines at center  
 Minimum Illumination ....0.8 lux at 40 IRE  
 White Balance .....Automatic, 2500°K to 7500°K  
 AES .....1/60 to 1/100,000 sec  
 Effective Pixels .....510 (H) x 492 (V)  
 Horizontal .....15.734 kHz  
 Vertical .....59.9 Hz

### Lens

Design .....Vari-focal, auto iris  
 Focal Length .....3.0 - 6.0 mm  
 Aperture .....f1.4  
 Viewing Angle  
 Horizontal .....105.1° - 53.2°  
 Vertical .....77.4° - 39.8°

### Electrical

Input Voltage .....12 VDC (±20%)  
 Power Consumption .....2.2 watts, maximum

### Mechanical

Dimensions (D x H) .....114 x 77.5 mm (4.49 x 3.05 in)  
 Unit Weight  
 (camera/lens/housing) ...0.06 kg (0.13 lbs)  
 Shipping Weight .....0.82 kg (1.80 lbs)  
 Housing Material .....ABS plastic  
 Housing Color .....Black or White

### Environmental

Operating Environment .....Indoor  
 Operating Temperature .....-10° to 50° C (14° to 122° F)  
 Humidity .....85% RH (non-condensing)  
 Storage Temperature .....-20° to 70° C (-4° to 158° F)

### Regulatory

Emissions .....FCC: Part 15, Class A  
 Safety .....UL: UL2044  
 cUL: C22-2, No. 1-98

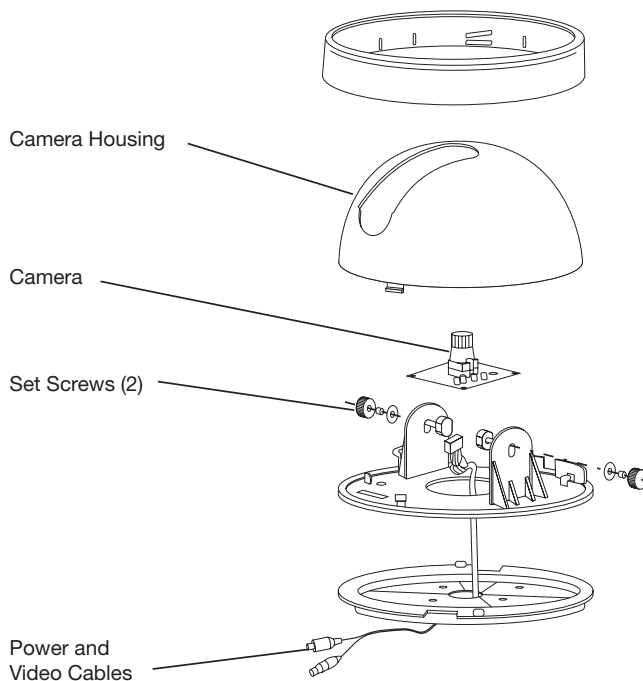

## Free Manuals Download Website

<http://myh66.com>

<http://usermanuals.us>

<http://www.somanuals.com>

<http://www.4manuals.cc>

<http://www.manual-lib.com>

<http://www.404manual.com>

<http://www.luxmanual.com>

<http://aubethermostatmanual.com>

Golf course search by state

<http://golfingnear.com>

Email search by domain

<http://emailbydomain.com>

Auto manuals search

<http://auto.somanuals.com>

TV manuals search

<http://tv.somanuals.com>