

## Party Pad Dance Mat

Designed for use with PS2™, PS3™, GAMECUBE™ and Wii™

Model: BH123

PlayStation®2 and PlayStation®3 are registered trademarks of Sony Computer Entertainment Inc. This product is not sponsored, endorsed or approved by Sony.

Nintendo®, GAMECUBE™ and Wii™ are either registered trademarks or trademarks of Nintendo® of America, Inc. This product is not sponsored, endorsed or approved by Nintendo®.

## CAUTIONS

- Make sure to read the Instruction Manual of the Dance Game before using the Party Pad.
- If you have any health concerns, please consult with your physician prior to using the Party Pad.
- Blockhead recommends that you take a break from playing once in awhile. Though dance competitions can get intense, please make sure to take a break at least every hour or so.
- Double check the area you plan on setting up the Party Pad. It is important to have enough room to bust it without knocking over lamps, running into tables or potentially breaking anything else you don't want to break.
- Make sure small children are supervised while dancing. Though Blockhead is ok with small children having a blast on the Party Pad, we want to ensure that the fun is being had in a safe manner – especially those kids 3 years old and younger.
- Keep the Pad out of environments of extreme heat and extreme cold.
- Take the time to flatten the Party Pad. This is the case especially the 1st time playing since the Pad had to be packed small to fit into the Retail Store.
- If you have any technical problems with the Pad, please contact Customer Service and do not try to fix the problem yourself as this would void your warranty and nobody wants that to happen.

1

## CAUTIONS

- In between dance sessions, please make sure to properly store the Party Pad. We did not design the Pad to be used as a rug. We suggest removing the cord from the game console and folding the pad in half to store.
- Don't get the Party Pad wet. This would void your warranty.
- If the Pad gets dirty, use a cloth and water only (no soap) to clean.

2

## FEATURES

- Compatible with PlayStation®2, PlayStation®3, Gamecube™ and Wii™ dancing games.  
(Note: Party Pad Dance Mat can not be connected with PlayStation®2, PlayStation®3, Gamecube™ and Wii™ at the same time).
- Top and bottom Non-slip surfaces.
- 10 high performance action pads and buttons.
- This product is not compatible with extension cables.

3

## CONNECT

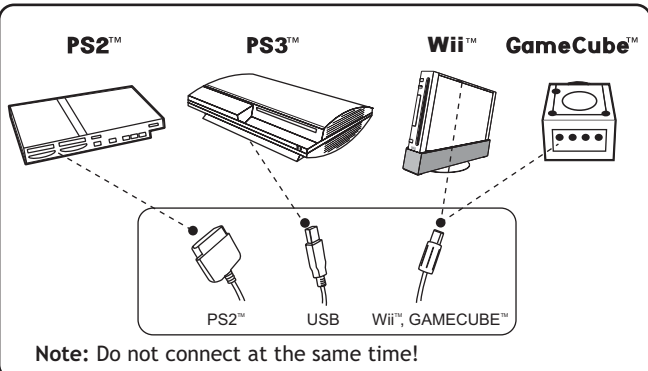

## BUTTON CONFIGURATION

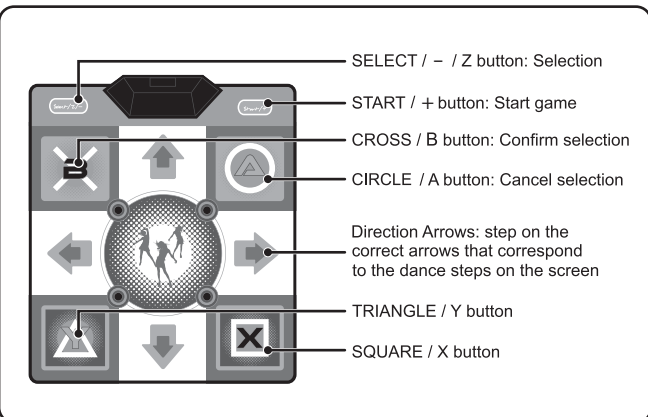

4

## WARRANTY AND TECHNICAL SUPPORT

Every Blockhead branded product comes with a 90 day warranty (U.S. Only). Blockhead will replace, repair or refund any defective products or components at no charge to you within 90 days of the purchase date. This warranty does not apply if the Blockhead branded product has been damaged by misuse, neglect, or reasons unrelated to defective materials or assembly. Blockhead is not responsible or liable for loss of data or loss of equipment use. You must retain a copy of your original receipt for warranty support.

For support on Blockhead products, contact us by visiting [www.blockheadgaming.com](http://www.blockheadgaming.com) or call us at 727-431-0650.

For general questions, comments, information or grammar tips, email us at [info@blockheadgaming.com](mailto:info@blockheadgaming.com).

## FCC INFORMATION

This equipment has been tested and found to comply with the limits for a class B digital device, pursuant to part 15 of the FCC rules. These limits are designed to provide reasonable protection against harmful interference in a residential installation. This equipment generates, uses, and can radiate radio frequency energy and, if not installed and used in accordance with the instructions, may cause harmful interference to radio communications. However, there is no guarantee that interference will not occur in a particular installation. If this equipment does cause harmful interference to radio or television reception, which can be determined by turning the equipment off and on, the user is encouraged to try to correct the interference by one or more of the following measures:

- Reorient or relocate the receiving antenna.
- Increase the separation between the equipment and the receiver.
- Connect the equipment into an outlet on a circuit different from that to which the receiver is connected.
- Consult the dealer or an experienced radio/TV technician for help.

Note: Changes or modifications not expressly approved by the party responsible for compliance could void the user's authority to operate equipment.

5

## Free Manuals Download Website

<http://myh66.com>

<http://usermanuals.us>

<http://www.somanuals.com>

<http://www.4manuals.cc>

<http://www.manual-lib.com>

<http://www.404manual.com>

<http://www.luxmanual.com>

<http://aubethermostatmanual.com>

Golf course search by state

<http://golfingnear.com>

Email search by domain

<http://emailbydomain.com>

Auto manuals search

<http://auto.somanuals.com>

TV manuals search

<http://tv.somanuals.com>