

BOLENS

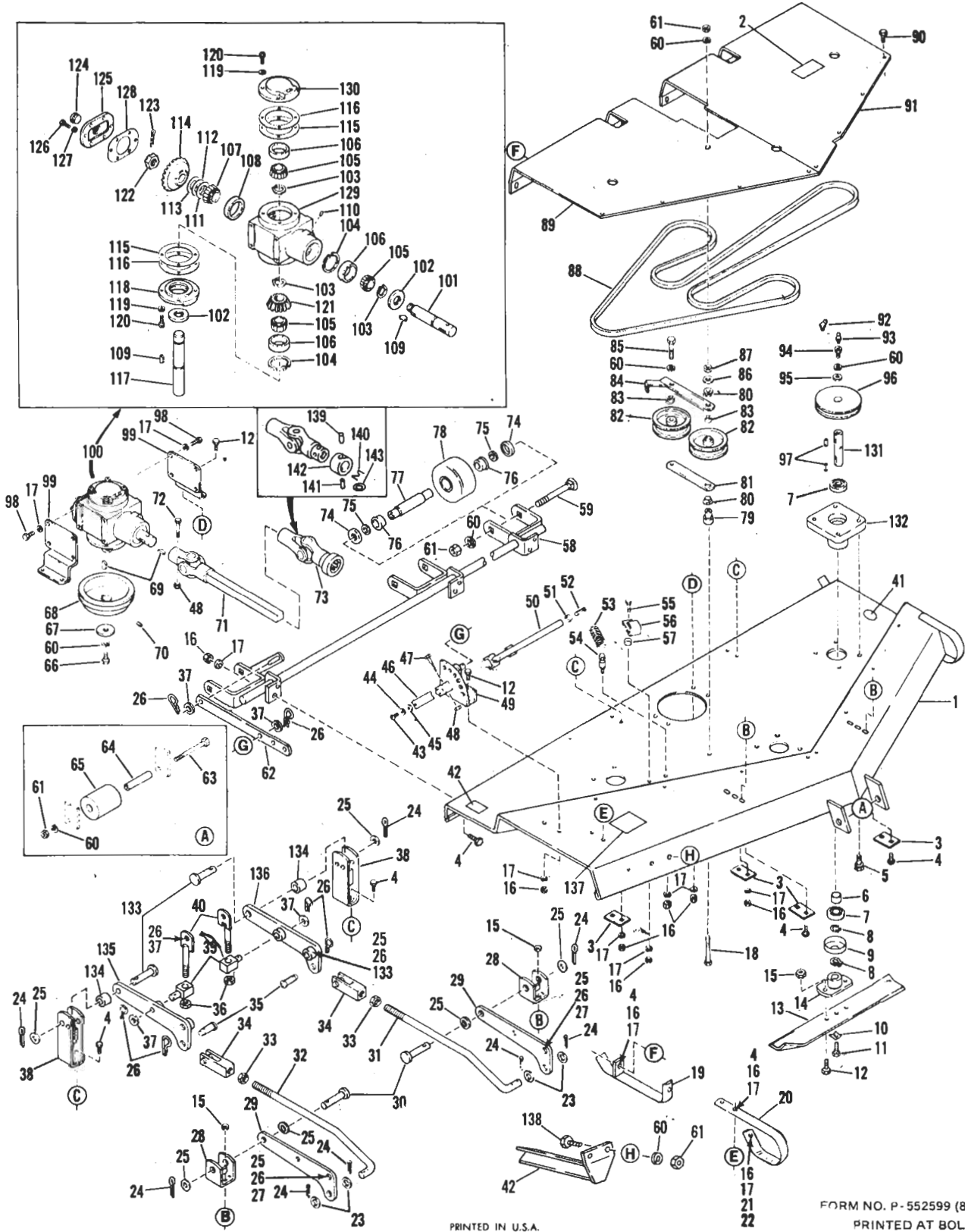

ILLUSTRATED PARTS LIST

FMC CORPORATION®
54 INCH CENTER MOUNTED
ROTARY MOWER ATTACHMENT
MODEL 18070-03



PRINTED IN U.S.A.

FORM NO. P-552599 (8/72)
PRINTED AT BOLENS

54" ROTARY MOWER MODEL 18070-03

Ref. No.	Part No.	Description	No. Req'd.
1	1725 651	Base Assembly	1
2	1724 840	Decal, Belt Drive	1
3	1720 372	Support Plate	4
4	1100 078	Capscrew, 5/16-18 x 7/8	18
5	1185 670	Capscrew, 5/16-18 x 7/8 with Lockwasher	12
6	1720 999	Spacer	3
7	1185 828	Ball Bearing	6
8	1185 708	Retaining Ring	6
9	1716 744	Cap	3
10	1185 715	Lockwasher, 3/8 (Pyramidal Type)	3
11	1100 009	Capscrew, 3/8-24 x 1	3
12	1100 044	Capscrew, 5/16-18 x 3/4	12
13	1722 883	Cutter Blade	3
14	1722 882	Hub Assembly	3
15	1110 107	Lock Nut, 5/16-18	10
16	1186 230	Hex Nut, 5/16-18	23
17	1100 242	Lockwasher, 5/16	31
18	1111 614	Capscrew, 3/8-16 x 3	1
19	1722 899	Rear Runner Assembly	1
20	1722 896	Right Hand Runner	1
21	1100 043	Capscrew, 5/16-18 x 1	1
22	1803 327	Flat Washer, 5/16	1
23	1107*387	Flat Washer, 3/8	4
24	1100 351	Cotter Pin, 1/8 x 1-1/4	8
25	1107 386	Flat Washer, 5/8	10
26	1723 478	Spring Cotter	12
27	1713 501	Clevis Pin	2
28	1722 947	Lift Bracket Assy., Front	2
29	1722 726	Right Hand Link	2
30	1708 040	Clevis Pin	2
31	1722 805	Left Hand Rod	1
32	1722 806	Right Hand Rod	1
33	1186 235	Hex Nut, 5/8-11	2
34	1714 573	Rod End	2
35	1719 324	Clevis Pin	2
36	1110 110	Lock Nut, 1/2-13	2
37	1107 385	Flat Washer, 1/2	6
38	1722 720	Rear Lift Bracket Assy.	2
39	1724 316	Stud	2
40	1715 404	Link Assembly	2
41	1722 725	Decal (Caution)	1
42	1725 487	Deflector	1
43	1114 748	Machine Screw, #10-32 x 1/2	1
44	1100 240	Lockwasher, #10	1
45	1103 959	Flat Washer, #10	1
46	1725 403	Spring	1
47	1100 811	Capscrew, 1/4-20 x 1-1/2	1
48	1110 106	Lock Nut, 1/4-20	2
49	1718 667	Quadrant Assembly	1
50	1718 664	Handle Assembly	1
51	1719 328	Spacer	1
52	1891 696	Roll Pin, 5/16 x 1-1/2	1
53	1706 822	Extension Spring	1
54	1715 210	Spring Anchor Bolt	1
55	1100 799	Capscrew, 5/16-18 x 1-1/2	1
56	1719 338	Belt Guide	1
57	1722 948	Spacer	1
58	1722 894	Wheel Yoke Assembly	1
59	1186 143	Carr. Bolt, 3/8-16 x 4-1/2	3
60	1100 243	Lockwasher, 3/8	12
61	1186 231	Hex Nut, 3/8-16	7
62	1722 888	Lift Link	1
63	1103 230	Capscrew, 3/8-16 x 6	1
64	1720 578	Spacer	1
65	1720 577	Roller	1
66	1111 708	Capscrew, 3/8-24 x 5/8	1
67	1703 052	Flat Washer	1
68	1718 659	Sheave	1
69	1100 276	Woodruff Key, 1/4 x 7/8	2
70	1103 466	Set Screw, 5/16-18 x 3/8	2
*71	1722 632	Drive Assembly	1
72	1111 601	Capscrew, 1/4-20 x 1-3/4	1

Ref. No.	Part No.	Description	No. Req'd.
*73	1723 790	Universal Joint Assy. (Incl. Ref. Nos. 139 thru 143)	1
74	1894 386	Cupped Washer	6
75	1705 108	Flat Washer	6
76	1185 695	Ball Bearing	6
77	1717 737	Bearing Axle	3
78	1717 649	Roller	3
79	1722 884	Idler Spacer	1
80	1714 299	Nylon Bushing	2
81	1718 649	Idler Arm	1
82	1724 488	Idler Pulley	2
83	1718 651	Spacer	2
84	1718 642	Idler Arm Assembly	1
85	1100 012	Capscrew, 3/8-24 x 1-3/4	1
86	1100 265	Flat Washer	1
87	1186 259	Jam Nut, 3/8-16	1
88	1718 653	V-Belt	1
89	1722 903	Right Hand Belt Cover	1
90	1185 712	Self Thread Screw, #10-20 x 1/2	17
91	1722 902	Left Hand Belt Cover	1
92	1110 086	Grease Fitting, 45°	1
93	1104 954	Grease Fitting	1
94	1719 331	Bolt	3
95	1701 055	Flat Washer	3
96	1722 886	Pulley	3
97	1108 852	Square Key, 3/16 x 3/4	6
98	1103 195	Capscrew, 5/16-18 x 5/8	8
99	1722 901	Support Bracket	2
100	1718 650	Gear Box Assembly	1
101	1718 622	Input Shaft	1
102	1185 687	Oil Seal	2
103	1185 689	Retaining Ring	3
104	1118 735	Retaining Ring	2
105	1185 661	Bearing Cone	3
106	1185 660	Bearing Cup	3
107	1185 688	Bearing Cone	1
108	1185 118	Bearing Cup	1
109	1709 611	Woodruff Key, 1/4 x 7/8	2
110	182 682	Breather	1
111	1800 750	Shim, 1-1/2 x .003	1
112	1800 751	Shim, 1-1/2 x .005	1
113	1800 338	Shim, .015	1
114	1717 459	Gear, 29 T	1
115	1717 456	Gasket	10
116	1719 501	Gasket	2
117	1718 621	Shaft, Output	1
118	1717 454	Bearing Retainer	1
119	1100 242	Lockwasher, 5/16	8
120	1185 686	Capscrew, 5/16-18 x 3/4	8
121	1717 457	Bevel Pinion, 18 T	1
122	1185 662	Slotted Nut, 7/8-14 UNF	1
123	1100 352	Cotter Pin, 1/8 x 1-1/2	1
124	1185 685	Plug, 3/4-14 NPT	1
125	1717 448	Cover	1
126	1185 684	Capscrew, 1/4-20 x 5/8	6
127	1100 241	Lockwasher, 1/4	6
128	1717 449	Gasket Cover	1
129	1719 710	Gear Case (Incl. Nos. 107, 108, 111, 112 & 113)	1
130	1718 620	Bearing Retainer	1
131	1722 887	Drive Shaft	3
132	1722 865	Bearing Housing	3
133	1718 772	Clevis Pin	4
134	1718 555	Tubular Spacer	2
135	1724 317	Right Hand Link	1
136	1724 318	Left Hand Link	1
137	1725 503	Decal (Cutting Hgt. Adj.)	1
138	1100 913	Capscrew, 3/8-16 x 7/8	2
139	1118 922	Drive Pin, 3/16 x 1/2	1
140	1723 782	Return Spring	1
141	1187 762	Groove Pin, 3/16 x 3/8	1
142	1723 781	Locking Collar	1
143	1725 334	Thrust Washer	1

*1714 207 Repair Kit for Joint Marked 6N

*1714 208 Repair Kit for Joint Marked NEAPCO



Free Manuals Download Website

<http://myh66.com>

<http://usermanuals.us>

<http://www.somanuals.com>

<http://www.4manuals.cc>

<http://www.manual-lib.com>

<http://www.404manual.com>

<http://www.luxmanual.com>

<http://aubethermostatmanual.com>

Golf course search by state

<http://golfingnear.com>

Email search by domain

<http://emailbydomain.com>

Auto manuals search

<http://auto.somanuals.com>

TV manuals search

<http://tv.somanuals.com>