

# Dualit®

## Professional



STEAM STATION  
INSTRUCTION MANUAL

# THE DUALIT STEAM STATION

The Dualit Professional steam station makes quick work of the toughest ironing jobs. It has continuous steam available at the touch of a button and an easy-glide coating on the base plate to ensure a smooth operation. Ultra dry micrafine pressurised steam easily flattens out the toughest dried-in creases.

## IMPORTANT SAFEGUARDS

### CAREFULLY READ ALL THE INSTRUCTIONS

- Check that the socket has a protected earthing connection and that the current and fuses (at least 10A) correspond to specifications plate on the station.
- Use filtered water only. Failure to do so will invalidate the guarantee.

## IMPORTANT SAFEGUARDS

- If the plug does not comply with your power supply, have it changed by a qualified electrician.
- The electric safety of the appliance is only guaranteed when it is connected to a correctly earthed connection according to official standards. If you are in doubt, consult your electrician.
- The pressure steam ironing station should not be moved while it is in operation.
- It is essential that it be set up on a surface that is not susceptible to high temperatures.
- This appliance is only intended for domestic use. Every other use is inappropriate and dangerous.
- Never touch the appliance with wet or damp hands.
- Never use the appliance in the bathroom.
- Never pull the plug out of the socket by tugging at the cable.
- Never expose the appliance to the elements e.g. rain, sun, ice etc.
- Do not let children use the ironing station; they cannot recognise the inherent dangers of handling electrical devices.
- Never plunge the appliance in water.
- Never expose the appliance to frost.
- Leads and cables must not come into contact with the hot iron.

## IMPORTANT SAFEGUARDS

- Do not direct the steam towards people or animals (danger of scalding). Avoid steam contact with unprotected skin.
- Switch off when not in use & unplug from the mains. Do not leave the appliance switched on unnecessarily.
- Never leave the iron unattended when it is connected to the mains.
- To guard against accidents, a faulty mains cable may only be replaced by the manufacturer, service agent or similarly qualified person.
- The iron must be used and rested on a stable surface.
- When placing the iron on its stand, ensure that the surface on which the stand is placed is stable.
- The iron is not to be used if it has been dropped, if there are visible signs of damage or if it is leaking.

- The pressure release valve (12) is an excess pressure seal. Never replace this with any other type of seal.
- Steam and boiling water could escape from the unit. DO NOT OPEN the tank seal (12), until the water reservoir (14) has cooled down to room temperature.
- **NEVER** try to fill the pressure steam unit through the tank seal (12). This is only for cleaning.

## SAVE THESE INSTRUCTIONS

### UNPACKING & INSPECTION

Unpack the unit and components from the shipping container.

Remove all visible packing material. If any damage is discovered, contact place of purchase or Dualit Ltd on 01293 652 500.

## STEAM STATION

Steam stations are made up of two main components: a container that holds the water for steam ironing and an iron without a water tank.

The main body has a heating element that boils the water and a valve that lets the steam through a hose into the iron.

An electric cord for the soleplate combined with a rubber hose for the steam supply connect the two components.

The thermostat for the iron soleplate is located on the iron the same place as for conventional irons and there's a steam pulse button that you press for steam ironing.

Vertical steaming is possible due to this component arrangement, which is ideal for ironing and freshening up curtains and suits.

## DESCRIPTION OF PARTS

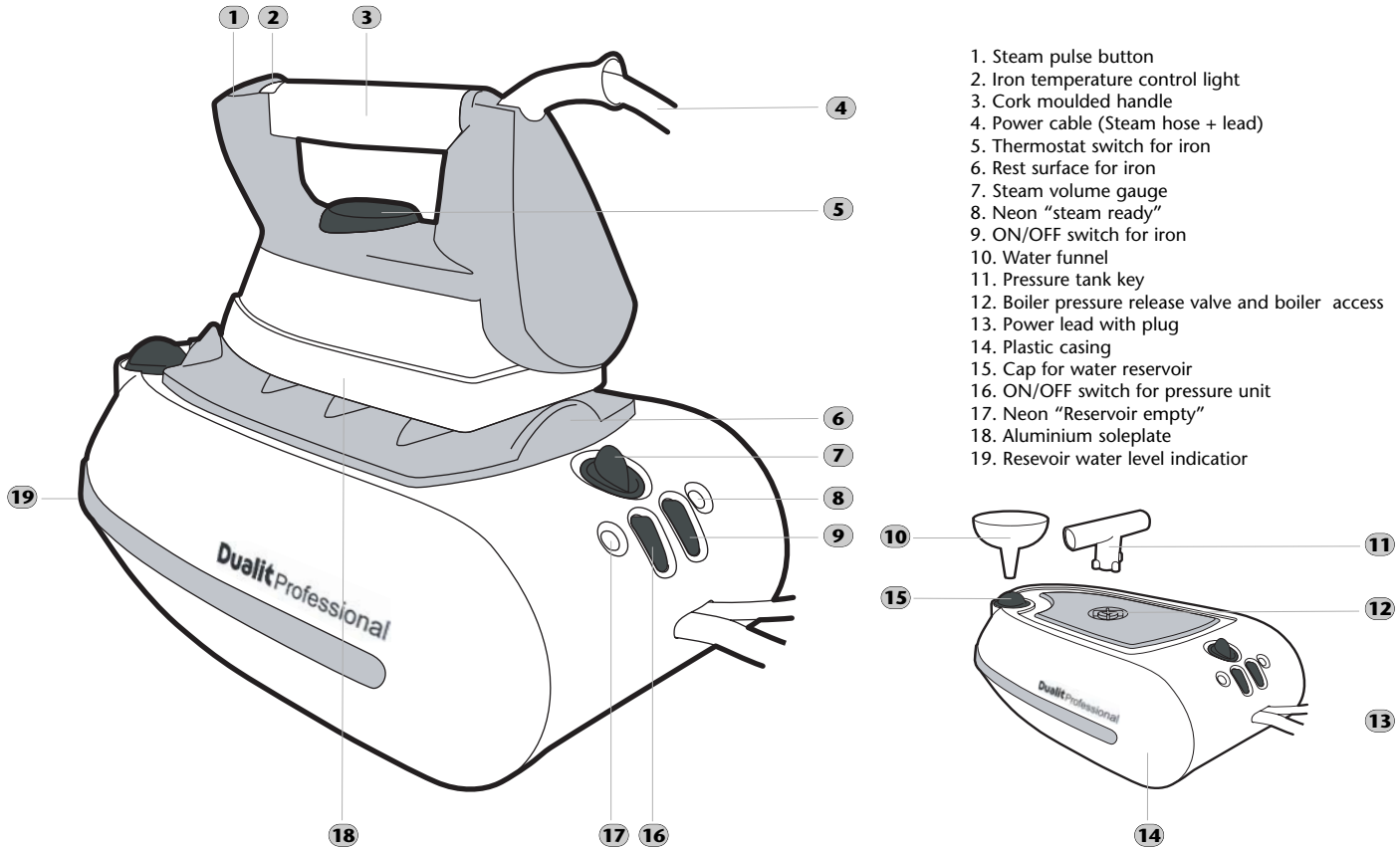

## IRONING WITH STEAM

- Check that the item you want to iron is suitable for steam ironing.
- Unscrew the water reservoir cap (15) and fill with filtered water. Use the supplied funnel(10). The water reservoir may be topped up at anytime.
- Screw on the water reservoir cap (15) and plug in to the mains (14).
- Turn on the pressure unit (16) and the iron (9).
- Adjust the thermostat switch (5) to the required temperature. The steam range is marked in blue on the thermostat dial.

### STEAM - JETS OR CONTINUOUS

- The pressure steam unit reaches ironing pressure in 3 minutes.
- The "steam ready" light (8) lights up

when the unit is ready to start ironing. It is perfectly normal for the lamp to switch off again.

- The "steam ready" light switches off and on while you are ironing without affecting the ironing in anyway.
- The pressure steam unit will emit a humming sound from time to time while you are ironing. This indicates that water is being pumped from the water reservoir into the pressure steam unit. This sound is normal and does not mean that something wrong.
- Press the steam pulse button (1) for steam pressure. Press and hold this button for continuous and steady flow of steam.
- Press the steam pulse button (1) repeatedly, at short intervals, to let the steam out of the boiler resevoir.

## STEAM VOLUME CONTROL

- The desired steam volume can be set with the steam volume gauge (7).
- Turning clockwise increases the steam volume, turning anticlockwise reduces the steam.
- If the "tank empty" neon (17) lights up, the water reservoir is empty and must be topped up. This is possible without any interruption. **Continuing to iron, without topping up with water, can damage the steam system.**

## VERTICAL STEAMING

Suits, jackets and curtains can be ironed or freshened up on the hanger using the vertical steaming function.

- Set the thermostat dial on the iron (5) to maximum temperature.
- Hang the garment on a clothes hanger and hold it lightly with one hand.

## VERTICAL STEAMING

- Press and hold the steam pulse button (1) and pass the iron from top to bottom along the material.

**Important:** Pass the soleplate direct along the material for cottons and linens. On delicate fabrics the sole of the iron should be kept several centimetres away from the material.

## IRONING WITHOUT STEAM

Some fabrics may not be suitable for steam ironing. You can use your steam station as a conventional iron with no steam.

- Connect the unit to the mains, press the iron On/Off switch (9).
- Select the required temperature with the thermostat switch (5).
- The control light (2) goes out as soon as required temperature is reached.
- The steam pulse button (1) should not be pressed when ironing without steam.

## CLEANING AND MAINTENANCE

It is imperative you follow this cleaning and maintenance guide to achieve best possible ironing results.

- Switch off after use and remove the plug from the socket.
- Always allow the iron to cool before putting it away.
- The water reservoir need not be emptied after ironing.
- Wipe the casing (14) from time to time with a damp cloth and rub dry.

### CLEANING THE SOLE PLATE

- When you have finished ironing place the iron on the rest(6). Take care that there are no traces of condensation under the sole plate as this could cause staining.
- Wiping the cold sole plate with a damp cloth is enough to keep it clean. Descaling agents should not be used to clean the appliance.

- The iron should not be passed over zips, buttons, rings, eyes etc. to prevent scratching the sole plate.

### CLEANING THE PRESSURE STEAM UNIT

We recommend you rinse out the steam pressure unit (12) before using the iron on day of cleaning and to rinse every two weeks. Do not use anything but water in steam pressure unit (never detergents).

**NOTE: All liability is excluded if the instructions are not followed.**

**Do not unscrew the pressure release valve until the pressure unit is no longer under pressure.**

- Ensure the plug is disconnected.
- Fully open the steam volume gauge (7) and release all excess steam with short pulses(1).
- Wait until fully de pressurised after using the iron, before opening the pressure valve.

## CLEANING AND MAINTENANCE

- Unscrew the pressure valve (12) anti clockwise using the key provided(11).
- Turn the steam unit upside down and empty it into the sink. This will let the deposits run off with the water. Fill the water reservoir with water again and rinse it out two or three times until all the deposit has been washed out.
- Screw the tank cap (12) back on and make sure it is properly closed.

## SPECIFICATIONS

### Technical ratings

Heating 2100 Watt

Pressure steam unit 1300 Watt

Iron 800 Watt

Power 230 Volt ~

Steam pressure 4 bar / 130 g/min.

Water reservoir capacity 1 litre

### Weight & Dimensions

Overall 4.9 kg

Pressure steam unit 3.6 kg

Iron 1.3 kg

Pressure steam unit and iron:

38x 25 x 29.5 cm

## GLOSSARY

**Steam Station** -invaluable for anyone who processes a lot of laundry. It cuts down ironing time as both sides of the garments are ironed at the same time. The iron unit is lighter and easier to use than conventional irons.

**Vertical steam** -This refers to an iron's capacity to produce steam when held upright. Vertical steam is useful for hanging garments such as suits and dresses, especially those made from delicate fabrics, or for ironing hanging curtains.

**Variable steam** - adjust steam generation for different fabrics, ranging from delicate synthetics to thick wool.

**Jet of steam** - A jet-burst feature provides instantaneous power on demand for especially challenging situations such as smoothing out difficult creases or for creating sharp creases on trousers.

**Continuous steam output** - A continuous steam facility makes ironing easier and more effective owing to the continuous impact it makes on 'taming' textile fibres.

## UK AFTER-SALES SERVICE

If your iron fails within one year from date of purchase we will repair or replace it free of charge provided:

- You use filtered water only.
- You have not misused, neglected or damaged it.
- It has not been modified.
- You supply your receipt to show when you bought your iron.

The guarantee does not affect your statutory rights.

If over one year contact Dualit for recommended repair agents.

Further advice on your Dualit steam station iron a is available from:

Dualit Customer Care  
Line on **+44(0) 1293 652 500**  
(09:00 to 17:00 Monday to Friday)

Alternatively email your enquiry to **info@dualit.com**.

**Dualit** <sup>®</sup>  CE Compliant to  
89/336/EEC (EMC directive) and 73/23  
& 93/68/EEC (LV directive)

DUALIT LIMITED COUNTY OAK WAY CRAWLEY WEST SUSSEX RH11 7ST

TELEPHONE: +44 (0) 1293 652 500 FACSIMILE: +44 (0) 1293 652 555

EMAIL: [info@dualit.com](mailto:info@dualit.com) WEB: [www.dualit.com](http://www.dualit.com)



## Free Manuals Download Website

<http://myh66.com>

<http://usermanuals.us>

<http://www.somanuals.com>

<http://www.4manuals.cc>

<http://www.manual-lib.com>

<http://www.404manual.com>

<http://www.luxmanual.com>

<http://aubethermostatmanual.com>

Golf course search by state

<http://golfingnear.com>

Email search by domain

<http://emailbydomain.com>

Auto manuals search

<http://auto.somanuals.com>

TV manuals search

<http://tv.somanuals.com>