

# Through Hole Power Inductors

## THAH1055, 1075, 1085, 1090 & 1095 Type

### Features

- RoHS compliant.
- High current ( Isat up to 50A ) through hole type.
- Magnetically shielded, suitable for high density mounting.
- High energy storage and low DCR.
- Provided with embossed carrier tape packing.
- Ideal for power source circuits, DC-DC converter, DC-AC inverters inductor application.
- In addition to the standard versions shown here, customized inductors are available to meet your exact requirements.

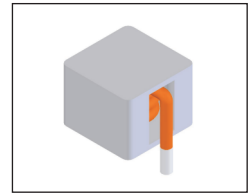

### Mechanical Dimension:

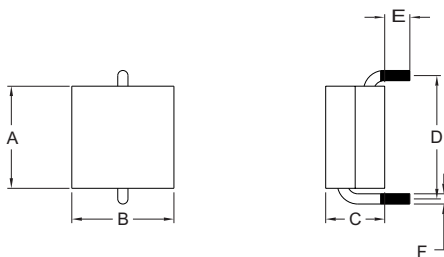

### RECOMMENDED PAD PATTERNS

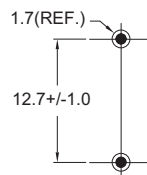

UNIT :mm/inch  
 A = 11.00 / 0.433 Max.  
 B = 11.00 / 0.433 Max.  
 D = 12.70±0.5 / 0.500±0.020  
 E = 3.30±0.5 / 0.130±0.020  
 F = 1.30 / 0.051

### Electrical Characteristics: At 25°C: 100KHz, 1.0V

PART NO.	Lo <sup>1</sup> (uH)	DCR (mΩ) MAX.	Isat <sup>2</sup> (A dc)	Irms <sup>3</sup> (A dc)	Dimension "C" (mm / inch) MAX
THAH1055-R15	0.150 ± 20%	0.50	45	30	5.50 / 0.217
THAH1075-R24	0.245 ± 10%	0.72 ± 7%	50	28	7.50 / 0.295
THAH1075-R25	0.280 ~ 0.308	0.76	40	28	7.50 / 0.295
THAH1075-OR3	0.224 ~ 0.336	0.76	40	28	7.50 / 0.295
THAH1075-R36	0.360 ± 20%	0.76	40	28	7.50 / 0.295
THAH1075-R68	0.680 ± 20%	1.25	35	25	7.50 / 0.295
THAH1075-OR8	0.800 ± 20%	2.30	35	20	7.50 / 0.295
THAH1075-1R0	1.000 ± 20%	3.00	22	16	7.50 / 0.295
THAH1085-OR9	0.900 ± 20%	2.10	30	22	8.50 / 0.335
THAH1090-OR4	0.400 ± 20%	1.15	40	25	9.00 / 0.354
THAH1090-OR5	0.500 ± 20%	0.90 ± 5%	50	40	9.00 / 0.354
THAH1095-1R2	1.200 ± 20%	3.00	22	15	9.50 / 0.374

1. Lo is the initial inductance.
2. Isat is the DC current which cause the inductance drop less than 20% of its nominal inductance without current.
3. Irms is the DC current which cause the surface temperature of the part increase less than 40°C.
4. Operating temperature : -40°C to 125°C ( including self-temperature rise ).



DELTA ELECTRONICS, INC.

(TAOYUAN PLANT CPBG) 252, SAN YING ROAD, KUEISAN INDUSTRIAL ZONE, TAOYUAN SHIEN, 333, TAIWAN, R.O.C.

TEL: 886-3-3591968; FAX: 886-3-3591991

http://www.deltawww.com

## Free Manuals Download Website

<http://myh66.com>

<http://usermanuals.us>

<http://www.somanuals.com>

<http://www.4manuals.cc>

<http://www.manual-lib.com>

<http://www.404manual.com>

<http://www.luxmanual.com>

<http://aubethermostatmanual.com>

Golf course search by state

<http://golfingnear.com>

Email search by domain

<http://emailbydomain.com>

Auto manuals search

<http://auto.somanuals.com>

TV manuals search

<http://tv.somanuals.com>