

# iHome

# iBT52

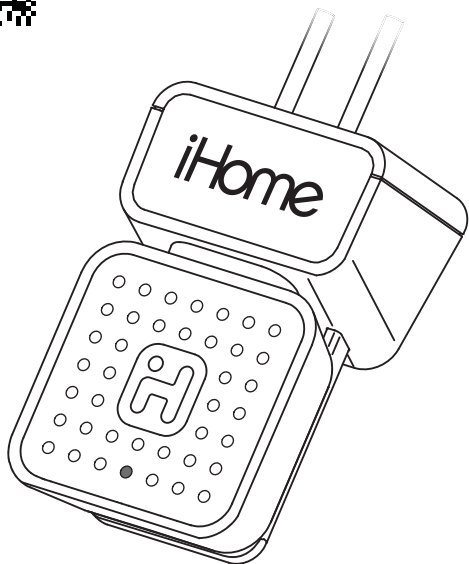

## ***Portable USB Bluetooth Receiver***



## Instruction manual

Download from [www.Somanuals.com](http://www.Somanuals.com). All Manuals Search And Download.

# Introduction

Thank you for purchasing the iHome iBT52. This product is designed to provide high quality wireless sound and speakerphone capability to audio devices equipped with line-in jacks, and to headphones.

Along with the included Quick Bluetooth Connection Guide this instruction booklet explains the basic operation and care of the unit. Please read them carefully and keep for future reference.

## Maintenance

- Keep unit away from sources of excessive heat.
- Clean your unit with a soft cloth moistened only with mild soap and water. Stronger cleaning agents, such as thinner or similar materials can damage the surface of the unit.

## Included

- iBT52 Bluetooth receiver system (Bluetooth Receiver + docking station with USB + audio cable)
- iBT52 Home Docking Station (with attached Aux + Micro USB cable)
- USB Wall Adaptor
- 3.5mm to RCA cable adapter

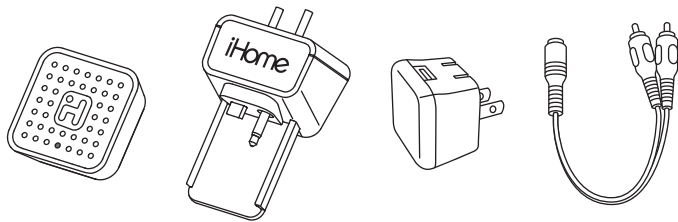

# Meet Your iBT52

## iBT52 Home Docking Station

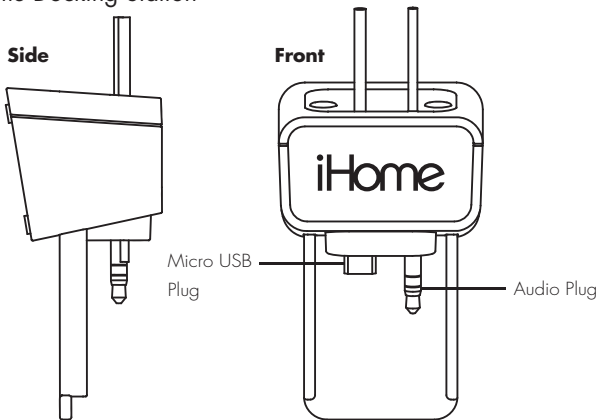

## iBT52 Bluetooth Receiver

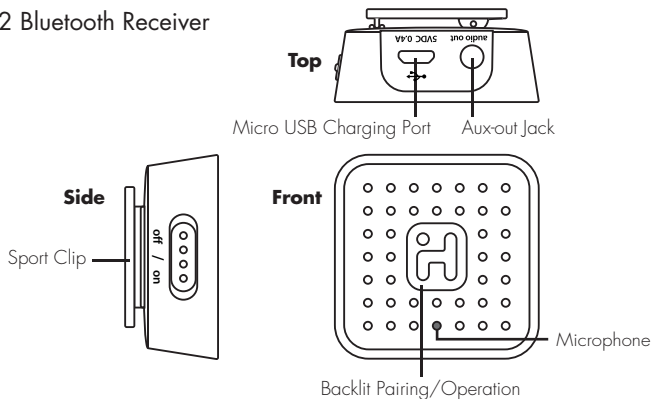

# Powering and Charging the Unit

## Using the USB Wall Adaptor

1. Gently connect the Bluetooth Receiver to the Docking Station's micro USB plug and audio plug by sliding the Receiver onto the plugs.
2. Connect the standard USB plug of the Docking Station into the USB Wall Adaptor.
3. Plug the USB Wall Adaptor into a working wall outlet. For first time use, charge unit for about 3 hours.

## Using other USB Power Source

1. Gently but firmly connect the Bluetooth Receiver to the Docking Station's micro USB plug and audio plug by lining up the sport clip with the groove on the Docking Station and sliding the Receiver onto the plugs.
2. Connect the standard USB plug of the Docking Station into a power USB port on a computer or other USB charging device. For first time use, charge unit for about 3 hours.

The  **Button/Indicator Light** on the front of the Bluetooth Receiver glows red steadily while the unit is charging and turns OFF once the unit is fully charged. If unit is not powered on and is connected to USB power, the red light glows steadily to indicate unit is charging.

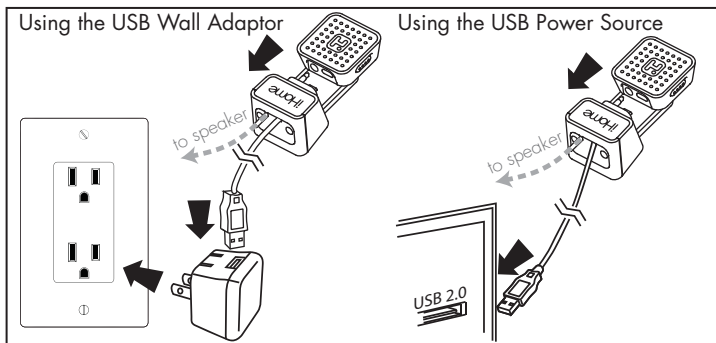

NOTE: When the unit is on and not connected to a power source, the  Button/Indicator light flashing, so manual should be Manual Setup And Download.

## Using Bluetooth: Pairing Your Device

1. Turn on your Bluetooth-enabled device and turn on Bluetooth capability as described in the device's user manual.
2. Move the **Power On/Off Switch** on the Bluetooth Receiver to the ON position (right) and wait 3 seconds. The unit will turn on and attempt to auto link to the last previously paired device for 10 seconds, indicated by the **⏻ Button/Indicator Light** on the front of the Receiver flashing blue. If a linked device is found, the indicator will flash blue twice every 7 seconds.
3. If no linked device is found, the unit will enter pairing mode, indicated by the **⏻ Button/Indicator Light** on the front of the Receiver flashing blue and red while the unit attempts to pair. **NOTE:** If the unit is charging while pairing is attempted, the light will continue to blink blue and red. "iHome iBT52" should appear on your device's menu. If "Not Paired", "Not Connected" or similar appears on your display, select "iHome iBT52" to complete pairing. If your device asks for a password, enter **0000** on the keyboard of your device. If no device is paired within 10 minutes, the unit will revert to auto link mode. To retry pairing, move the **Power On/Off Switch** to the OFF position (left) then move it back to the Bluetooth position (right) and wait 3 seconds.
4. Once paired with a device, the **⏻ Button/Indicator Light** on the front of the Receiver will flash blue twice every 7 seconds. There should be an indication on your device that pairing is complete. On some devices, you must then select "Use as Audio Device" or similar on the device's Bluetooth menu. Once paired, your device should link to the iBT52 whenever within range.

## Pairing with a Different Device

1. When you power ON the Receiver, it will automatically link with the last previously paired Bluetooth device as long as that device is still within range (about 30 feet). So, to pair with a different device you must activate pairing mode. To do so press and hold the **⏻ Button** for 6 seconds. The **⏻ Button/Indicator Light** flashes blue and red indicating pairing mode.

## Connecting Audio Source to Bluetooth Receiver

1. Connect the audio cable on the Docking Station to your desired speaker or audio device's line in jack. For portable use, connect headphones or an audio cable connected to a speaker or audio device to the Aux-out Jack on the Bluetooth Receiver (see diagram below).

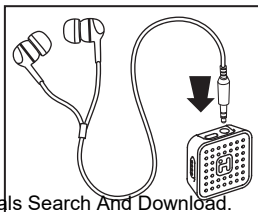

2. Move the **Power On/Off Switch** to the ON position (right) and wait 3 seconds to listen to audio streamed wirelessly from your paired iPad, iPhone, iPod or other Bluetooth device.

The **Bluetooth Button/Indicator Light** on the Receiver will flash blue as the unit searches for a previously paired device, and then flash blue twice every 7 seconds once a previously paired device is detected.

3. Press the **Bluetooth Button** to play or pause tracks. Use the controls on your device to navigate tracks and control volume from your Bluetooth device.
4. When done listening, move the **Power On/Off Switch** to the OFF position (left) to turn the unit off.

## Connecting Receiver to Speaker Using Aux Out

While the Bluetooth Receiver is docked in the Docking Station, you can connect the Docking Station to any external speaker or audio device with a speaker and aux/line-in jack via the Aux-out cable attached to the Docking Station.

You can also connect the Bluetooth Receiver directly by connecting a standard 3.5mm stereo audio cable to the Aux-out jack on the Bluetooth Receiver and the other end into the desired Line-in jack.

1. Connect a 3.5 mm audio cable plug to the Aux-out jack on back of the unit and connect the other end to the line-in jack on your external speaker. Note that the aux output signal is stereo.
2. Move the **Power On/Off Switch** to the ON position (right) to listen to audio via the selected mode.
3. Power on the audio device and use the controls on the device to navigate tracks and control volume. Press the **Bluetooth Button** to play or pause tracks.
4. When done listening, move the **Power On/Off Switch** to the OFF position (left) to turn the unit off. Remember to turn off your audio device, too.

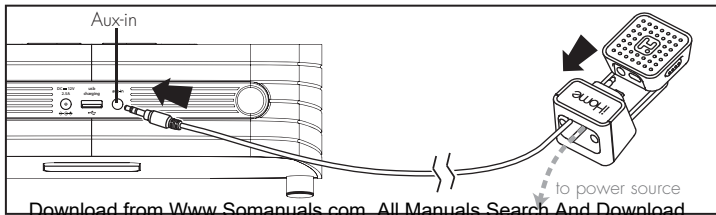

## Using with a Paired Phone

Pair your Bluetooth-capable phone as described under Pairing. While the Bluetooth Receiver is connected to an audio device such as a speaker or earphones, you can use the device as speakerphone.

**Answering Calls** Press and release the  **Button** to answer a call.

The LED flashes blue quickly while the phone is ringing and turns solid blue during the call.

**Ending Calls** Press and release the  **Button** to end a call.

The LED returns to standard mode (flashes twice every 7 seconds).

**Rejecting Calls** Press and hold the  **Button** for 1 second to reject a call.

The LED flashes blue quickly while the phone is ringing then returns to standard mode (flashes twice every 7 seconds).

**Voice Dialing** Press and hold the  **Button** for 3 seconds, then say the voice tag at the beep

Make sure to record voice tag into phone before attempting voice dial function. Only available on paired phones that have voice dial capability (see your phone's user guide).

**Redial** Press and release the  **Button** twice to redial the last number called.

**Call Waiting** Press and release the  **Button** to place a current call on hold and answer a new call.

Press and hold the  **Button** for 1 second to ignore a new call and stay with the current call.

Press and release the  **Button** twice to hang up on a current call and answer a new call.

# Troubleshooting

## Unit doesn't respond (no power)

- Make sure unit is completely charged.
- Check that all connections are correct and properly plugged in.
- Make sure your device is properly paired with the iBT52.
- Make sure the **Power On/Off Switch** switch is not in the OFF (left) position.

## Resetting the iBT52

If the unit becomes "locked up" or unresponsive, you may need to reset it. To do so, press and hold the iH Button for 6 seconds, the iH Button/Indicator Light flashes blue and red. Then press and hold the iH Button for 10 seconds. 2 long beeps indicate unit has been reset.

## Trouble pairing device/computer with iBT52

Bluetooth implementation varies depending on your device's hardware and operating system. Please see our website for updates on pairing.

- When you power ON the Receiver, it will automatically link with the last previously paired Bluetooth device if the device is still within range (about 30 feet). To pair with a different device you must turn off Bluetooth capability on the already paired device, or take it out of range.
- If your device does not auto-link when within range, re-pair the device. To do so, first delete the iBT52 from your Bluetooth devices menu. Move the **Power On/Off Switch** on the unit to the OFF position then back to ON to begin pairing (see Pairing Your Device for pairing details).
- Make sure your device is working properly. Check your device's manual for details on Bluetooth pairing and linking.

For further information and to see the latest instructions,

visit [www.ihomeaudio.com/support](http://www.ihomeaudio.com/support)



# Internal Rechargeable Lithium-ion Battery

This device uses an internal rechargeable lithium-ion battery that should last the lifetime of the device. If you suspect your battery may be dead, try charging it several times. If the battery does not recharge, please contact us for repair information.

## WARNING/DISPOSAL OF UNIT

Please do NOT attempt to change the battery yourself. If the battery has died and you do not want us to replace your battery, you should follow the disposal instructions below:

- Never dispose of used batteries/electronics with ordinary solid wastes, since they contain toxic substances.
- Always dispose of used batteries/electronics in accordance with the prevailing community regulations that apply to the disposal of batteries/electronics. If there are no local regulations concerning battery/electronics disposal, please dispose of the device in a waste bin for electronic devices.
- Many electronics retailers now recycle batteries and other electronic components at no charge. Check to see which ones in your area do so.

## CAUTION

**The battery used in this device may present a risk of fire, explosion or chemical burn if mistreated**

- Never use or charge the battery if it appears to be leaking, discolored, deformed, or in any way abnormal.
  - Never disassemble the unit or attempt to remove battery as that could cause leakage of alkaline solution or other electrolytic substance.
  - Always confirm that the temperature is 5°C – 35° C (41° - 95° Fahrenheit) before you charge the battery. Leakage or deterioration of the battery may occur if this warning is not heeded.
  - Never expose the battery to any liquid.
  - Never expose the battery to excessive heat such as direct sunlight or fire. Never use the battery pack in an unventilated vehicle where excessive internal temperatures may be encountered.
  - Always keep the battery out of the reach of infants and small children.
- Download from [www.Somanuals.com](http://www.Somanuals.com). All Manuals Search And Download.

# Consumer Product Safety Guide

## IMPORTANT SAFETY INSTRUCTIONS

When used in the directed manner, this unit has been designed and manufactured to ensure your personal safety. However, improper use can result in potential electrical shock or fire hazards. Please read all safety and operating instructions carefully before installation and use, and keep these instructions handy for future reference. Take special note of all warnings listed in these instructions and on the unit.

1. **Water and Moisture** – The unit should not be used near water. For example: near a bathtub, washbowl, kitchen sink, laundry tub, swimming pool or in a wet basement.
2. **Ventilation** – The unit should be situated so that its location or position does not interfere with its proper ventilation. For example, it should not be situated on a bed, sofa, rug or similar surface that may block ventilation openings. Also, it should not be placed in a built-in installation, such as a bookcase or cabinet, which may impede the flow of air through the ventilation openings.
3. **Heat** – The unit should be situated away from heat sources such as radiators, heat registers, stoves or other appliances (including amplifiers) that produce heat.
4. **Power Sources** – The unit should be connected to a power supply only of the type described in the operating instructions or as marked on the appliance.
5. **Power-Cable Protection** – Power supply cables should be routed so that they are not likely to be walked on or pinched by items placed upon or against them. It is always best to have a clear area from where the cable exits the unit to where it is plugged into an AC socket.
6. **Cleaning** – The unit should be cleaned only using a warm damp cloth. Do not use solvents, etc.
7. **Objects and Liquid Entry** – Care should be taken so that objects do not fall and liquids are not spilled into any openings or vents located on the product.
8. **Attachments** – Do not use attachments not recommended by the product manufacturer.
9. **Lightning and Power Surge Protection** – Unplug the unit from the wall socket and disconnect the antenna or cable system during a lightning storm or when it is left unattended and unused for long periods of time. This will prevent damage to the product due to lightning and power-line surges.
10. **Overloading** – Do not overload wall sockets, extension cords, or integral convenience receptacles as this can result in a risk of fire or electric shock.
11. **Damage Requiring Service** – The unit should be serviced by qualified service personnel when:
  - A. the power supply cable or plug has been damaged.
  - B. objects have fallen into or liquid has been spilled into the enclosure.
  - C. the unit has been exposed to rain.
  - D. the unit has been dropped or the enclosure damaged.
  - E. the unit exhibits a marked change in performance or does not operate normally.
12. **Periods of Nonuse** – If the unit is to be left unused for an extended period of time, such as a month or longer, the power cable should be unplugged from the unit to prevent damage or corrosion.
13. **Servicing** – The user should not attempt to service the unit beyond those methods described in the user's operating instructions. Service methods not covered in the operating instructions should be referred to qualified service personnel.

# FCC Information

## FCC Radiation Exposure Statement

FCC ID: EMOIBT52

IC: 986B-IBT52

This equipment complies with FCC RF radiation exposure limits set forth for an uncontrolled environment. This transmitter must not be co-located or operating in conjunction with any other antenna or transmitter.

This Device complies with RSS-102 of the IC Rules; Operation is subject to the following two conditions:

- (1) This device may not cause harmful interference and
- (2) This device must accept any interference received, including interference that may cause undesired operation.

**This device complies with Part 15 of the FCC Rules, operation is subject to the following two conditions: (1) This device may not cause harmful interference, and (2) this device must accept any interference received, including interference that may cause undesired operation.**

• Warning: Changes or modifications to this unit not expressly approved by the party responsible for compliance could void the user's authority to operate the equipment.

• NOTE: This equipment has been tested and found to comply with the limits for a Class B digital device, pursuant to Part 15 of the FCC Rules.

These limits are designed to provide reasonable protection against harmful interference in a residential installation. This equipment generates, uses and can radiate radio frequency energy and, if not installed and used in accordance with the instructions, may cause harmful interference to radio communications.

However, there is no guarantee that interference will not occur in a particular installation. If this equipment does cause harmful interference to radio or television reception, which can be determined by turning the equipment off and on, the user is encouraged to try to correct the interference by one or more of the following measures:

- Reorient or relocate the receiving antenna.
- Increase the separation between the equipment and receiver.
- Connect the equipment into an outlet on a circuit different from that to which the receiver is connected.
- Consult the dealer or an experienced radio/TV technician for help.

This Class B digital apparatus complies with Canadian ICES-003.

Cet appareil numérique de la classe B est conforme à la norme NMB-003 du Canada

# Information FCC

## FDéclaration de la FCC sur l'exposition aux radiations

Le présent appareil est conforme aux CNR d'Industrie Canada applicables aux appareils radio exempts de licence. L'exploitation est autorisée aux deux conditions suivantes : (1) l'appareil ne doit pas produire de brouillage, et (2) l'utilisateur de l'appareil doit accepter tout brouillage radioélectrique subi, même si le brouillage est susceptible d'en compromettre le fonctionnement.

Le dispositif rencontre l'exemption des limites courantes d'évaluation dans la section 2.5 de RSS 102 et la conformité à l'exposition de RSS-102 rf, utilisateurs peut obtenir l'information canadienne sur l'exposition et la conformité de rf.

**Cet appareil répond aux exigences du paragraphe 15 de la loi de la Commission Fédérale sur les Communications. L'utilisation de cet appareil doit répondre aux deux conditions suivantes: (1) Cet appareil ne doit pas provoquer d'interférences nuisibles, et (2) cet appareil doit accepter toutes les interférences reçues, y compris les interférences pouvant provoquer un fonctionnement non désiré.**

Avertissement : Tout changement ou modification apporté à cet appareil sans le consentement expresse de la partie responsable pour la conformité peut annuler le droit de l'utilisateur d'utiliser cet appareil.

Remarque : Cet équipement a été testé et jugé conforme aux limitations pour un appareil numérique de Classe B, selon la Section 15 de la réglementation FCC.

Ces limites sont conçues pour fournir une protection raisonnable contre les interférences nuisibles dans une installation résidentielle. Cet équipement génère, utilise et peut émettre des fréquences radio et, s'il n'est pas installé et utilisé selon les instructions, peut causer des interférences nuisibles aux communications radio.

Cependant, il n'existe aucune garantie que des interférences ne se produiront pas dans une installation particulière. Si cet équipement produit des interférences nuisibles sur la réception de la radio ou de la télévision, ce que vous pouvez facilement constater en éteignant et en rallumant l'équipement, nous vous encourageons à prendre l'une ou plusieurs des mesures correctives suivantes :

- Réorienter ou déplacer l'antenne réceptrice,
- Éloigner davantage l'appareil du récepteur.
- Branchez l'équipement sur une prise ou un circuit auquel le récepteur n'est pas branché.

• **Download from [www.Somanuals.com](http://www.Somanuals.com). All Manuals Search And Download.**  
appareils digitaux de Classe B compatible avec ICES-003 Canadien.

# Limited 1 Year Warranty

iHome Products, a division of SDI Technologies Inc. (hereafter referred to as SDI), warrants this product to be free from defects in workmanship and materials, under normal use and conditions, for a period of one (1) year from the date of original purchase.

Should this product fail to function in a satisfactory manner, it is best to first return it to the store where it was originally purchased. Should this fail to resolve the matter and service still be required by reason of any defect or malfunction during the warranty period, SDI will repair or, at its discretion, replace this product without charge. This decision is subject to verification of the defect or malfunction upon delivery of this product to the Factory Service Center authorized by SDI Customer Service. The product must include proof of purchase, including date of purchase. An out-of-warranty fee for service will be charged for units that are received without proof of purchase.

Before returning this product for service, please first replace the batteries (if applicable) with fresh ones, as exhausted or defective batteries are the most common cause of problems encountered. If service is still required:

1. Call SDI Customer Service at 1-800-288-2792 for Return Authorization and for the address of the Factory Service Center.
2. Remove the batteries (if applicable) and pack the unit in a well padded, heavy corrugated box. SDI is not responsible for damage that occurs during shipping to the Factory Service Center.
3. Enclose a photocopy of your sales receipt, credit card statement, or other proof of the date of purchase, if within the warranty period. Also include your name and address information, a brief description for why the unit is being returned, and the return authorization number. No unit can be processed without a return authorization number.
4. Write the return authorization number on the side of the shipping package and send the unit prepaid and insured to the Factory Service Center address authorized by SDI Customer Service.

## Disclaimer of Warranty

NOTE: This Warranty is valid only if the product is used for the purpose for which it was designed. It does not cover (i) products which have been damaged by negligence or willful actions, misuse or accident, or which have been modified or repaired by unauthorized persons; (ii) cracked or broken cabinets, or units damaged by excessive heat; (iii) damage to digital media players, CD's or tape cassettes (if applicable); (iv) the cost of shipping this product to the Factory Service Center and its return to the owner.

This warranty is valid only in the United States of America and does not extend to owners of the product other than to the original purchaser. In no event will SDI or any of its affiliates, contractors, resellers, their officers, directors, shareholders, members or agents be liable to you or any third party for any consequential or incidental damages, any lost profits, actual, exemplary or punitive damages. (Some states do not allow limitations on implied warranties or exclusion of consequential damages, so these restrictions may not apply to you.) This warranty gives you specific legal rights, and you may also have other rights which vary from state to state.

Your acknowledgement and agreement to fully and completely abide by the above mentioned disclaimer of warranty is contractually binding to you upon your transfer of currency (money order, cashier's check, or credit card) for purchase of your SDI product.

© 2013 SDI Technologies, Inc. All rights reserved

Questions? Visit [www.ihomeaudio.com](http://www.ihomeaudio.com)

or call 1-800-288-2792 Toll Free

## Free Manuals Download Website

<http://myh66.com>

<http://usermanuals.us>

<http://www.somanuals.com>

<http://www.4manuals.cc>

<http://www.manual-lib.com>

<http://www.404manual.com>

<http://www.luxmanual.com>

<http://aubethermostatmanual.com>

Golf course search by state

<http://golfingnear.com>

Email search by domain

<http://emailbydomain.com>

Auto manuals search

<http://auto.somanuals.com>

TV manuals search

<http://tv.somanuals.com>